

CONVERSATION MGP PATIO CHAIR

KCF2415
REV. 1
11/13/24

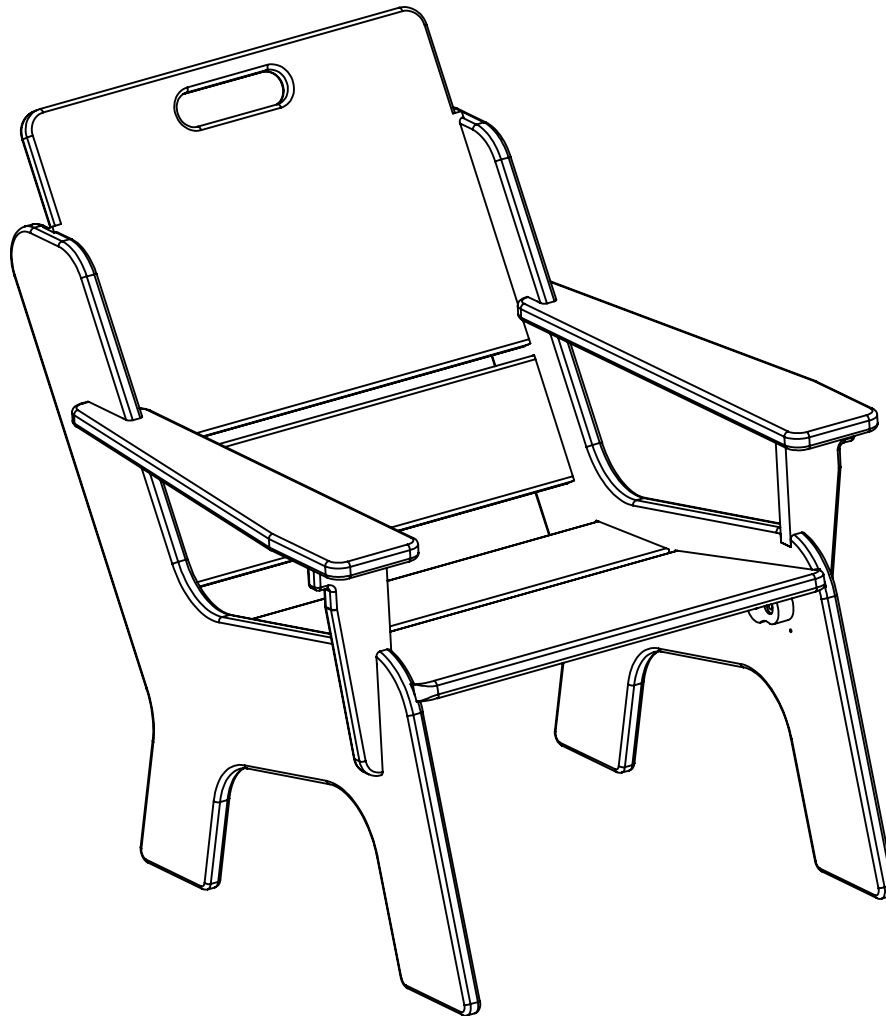

CONVERSATION MGP PATIO CHAIR

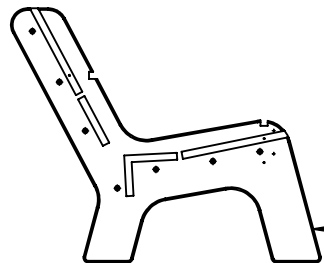

(A) RIGHT SIDE
QTY. = 1

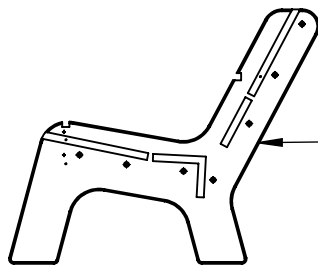

(B) LEFT SIDE
QTY. = 1

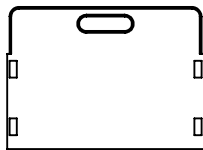

(C) BACK REST
QTY. = 1



(D) SEAT FRONT
QTY. = 1



(E) SMALL SLAT
QTY. = 2

SWAY PIECE
QTY. = 1



LEFT ARM
QTY. = 1

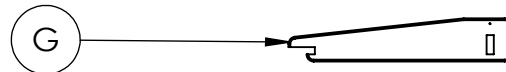

RIGHT ARM
QTY. = 1

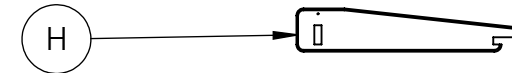

ARM SUPPORT
QTY. = 2



CAM
QTY. = 14



#8 X 1-5/8" SCREW
QTY. = 8

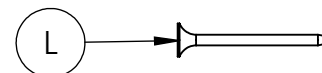

1/4-20 x 1-1/4"
FLATHEAD SCREW
QTY. = 14

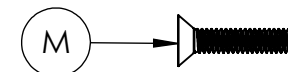

(PARTS SHOWN AT DIFFERENT SCALES)

CONVERSATION MGP PATIO CHAIR

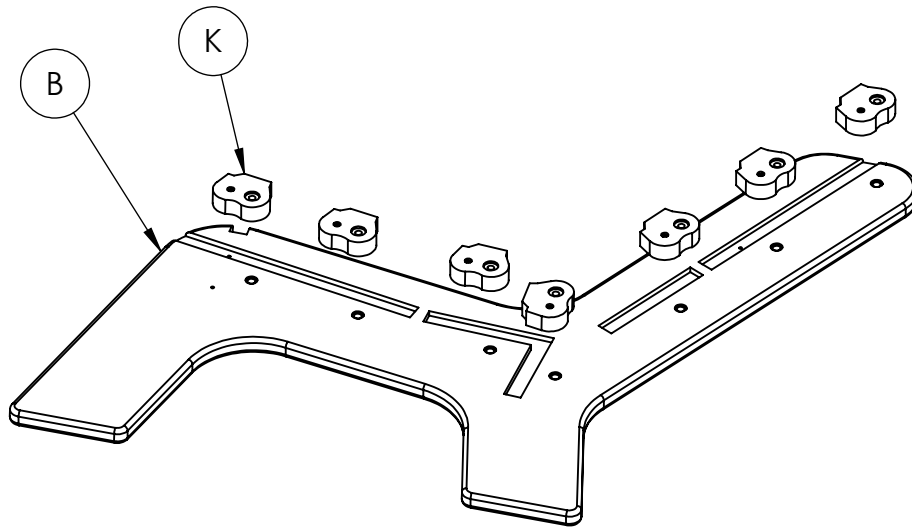

STEP ONE: ATTACH ALL CAMS (K) TO LEFT AND RIGHT LEGS. INSURE THAT ALL CAMS ARE ORIENTED AS SHOWN, WITH THE COUNTERBORED HOLE FACING UP. USE 1-1/4" FLATHEAD SCREWS (M). DO NOT TIGHTEN ALL THE WAY.

REQUIRED TOOLS (NOT INCLUDED)

1 - SCREW GUN

1 - #2 SQUARE DRIVE/ PHILLIPS BIT

NOTE: IT IS IMPORTANT TO KEEP ALL BOLTS FINGER TIGHT DURING ASSEMBLY UNTIL ENTIRE TABLE IS ASSEMBLED

**INSTALL CAMS
TO SIDES**

2/7

CONVERSATION MGP PATIO CHAIR

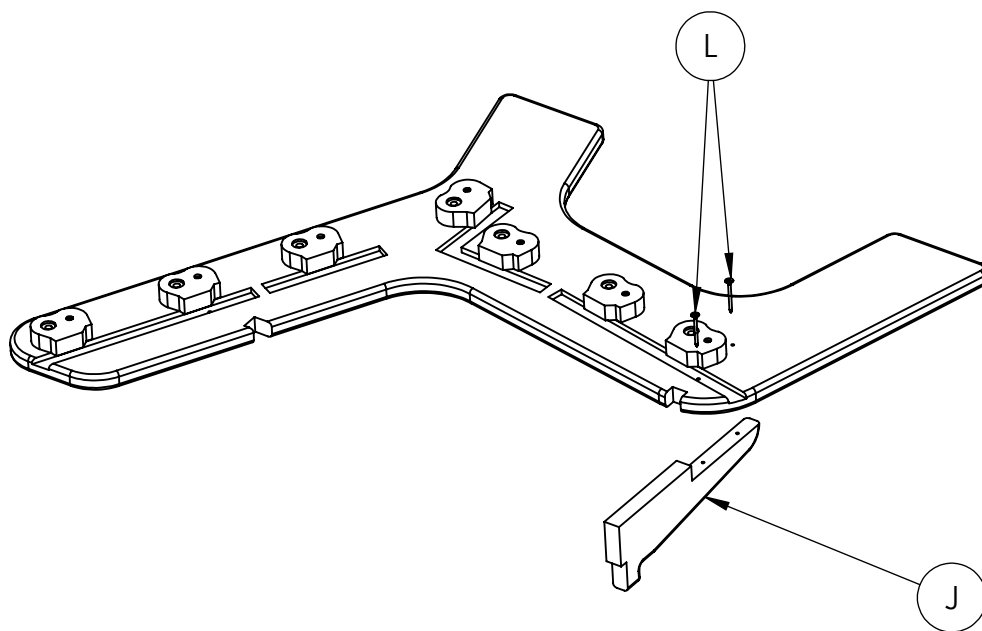

STEP TWO: ATTACH THE ARM SUPPORT TO EACH LEG USING (2) 1-1/4" SCREWS (L). IT IS EASIEST TO PLACE THE LEG ON A TABLE AND LET THE ARM SUPPORT HANG OVER THE SIDE WHEN DOING THIS STEP. TIGHTEN FULLY.

CONVERSATION MGP PATIO CHAIR

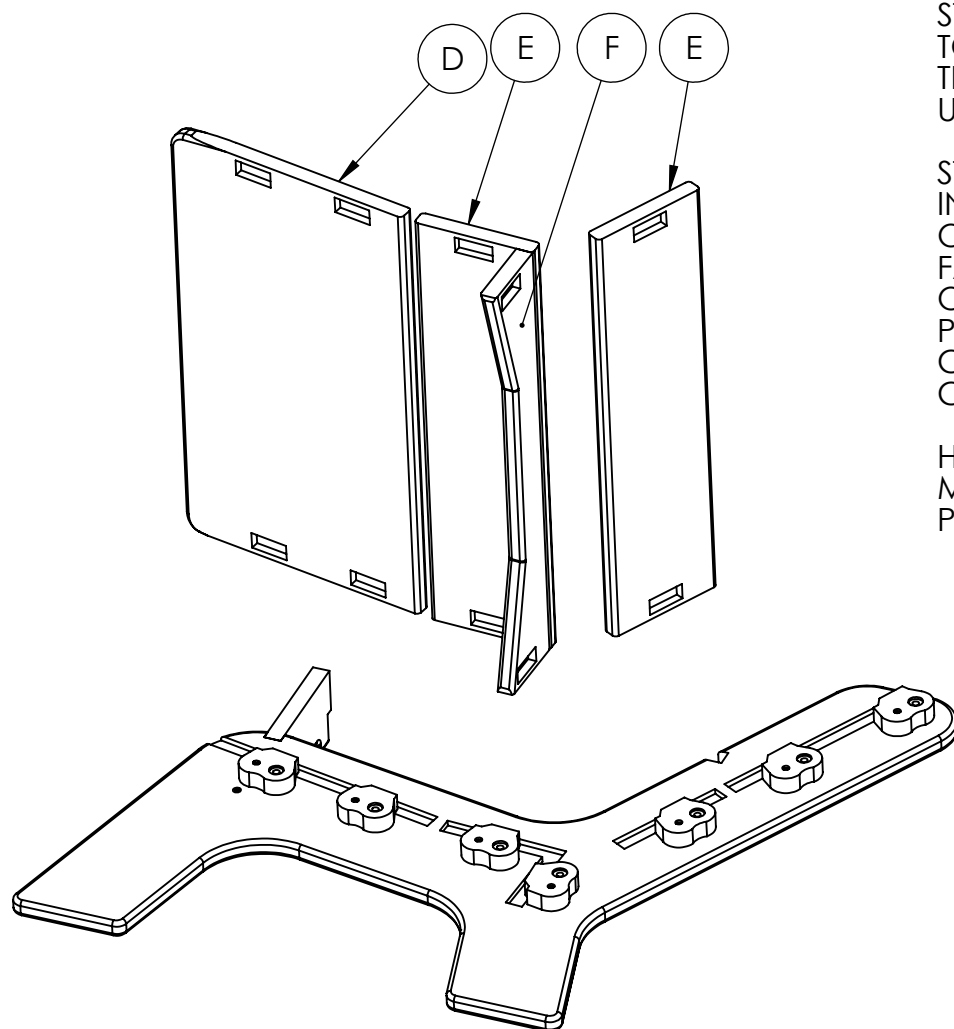

STEP THREE: BECAUSE THE ARM SUPPORT IS ATTACHED TO THE SIDE PIECE, EITHER HAVE IT ON A TABLE WITH THE ARM SUPPORT HANGING OVER THE SIDE, OR BLOCK UP THE OTHER END OF THE SIDE SO IT SITS LEVEL.

START BY FITTING THE SWAY PIECE (F), INTO THE SLOT IN WHICH EVER SIDE YOU'RE STARTING WITH (EITHER LEFT OR RIGHT). MAKE SURE THE RECTANGULAR CUTOUTS ARE FACING THE DIRECTION AS SHOWN (TOWARDS THE BACK OR THE CHAIR). THEN FIT THE OTHER SEAT AND SEAT BACK PIECES IN AS SHOWN. ONCE ALL INSERTED, ROTATE THE CAMS TO LOCK THEM IN PLACE. DO NOT TIGHTEN THE CAM SCREWS YET.

HINT: THE LARGEST PANEL IS USED IN THE LAST STEP. THE MAIN SEAT PIECE SHOWN HERE IS THE SECOND LARGEST PANEL.

CONVERSATION MGP PATIO CHAIR

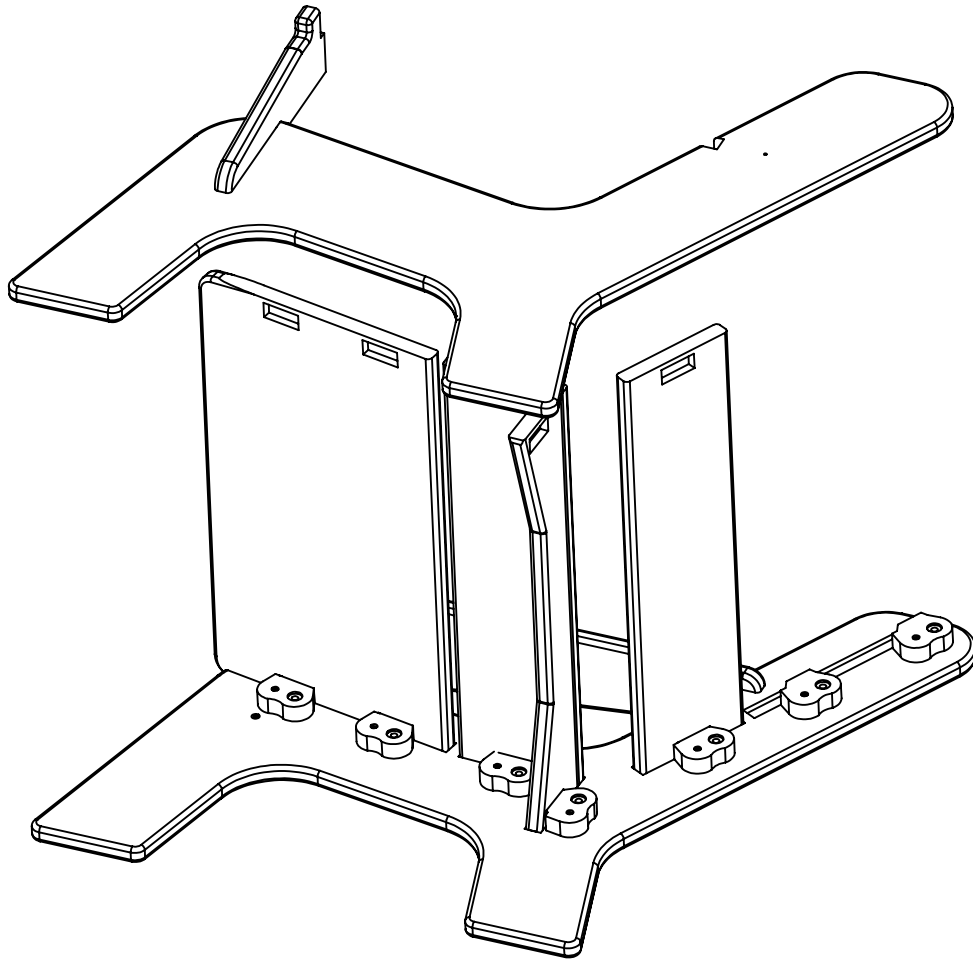

STEP FOUR: LOWER THE OTHER SIDE OF THE CHAIR ONTO PIECES STICKING UP. IT HELPS TO KEEP THE CAMS LOOSE AND ROTATED OUT OF THE WAY AT THIS POINT.

IT ALSO HELPS TO HAVE ANOTHER PERSON AVAILABLE TO GUIDE PIECES INTO THE SLOTS. ONCE ALL THE PIECES ARE SEATED INTO THE SLOTS, ROTATE THE CAMS INTO THE CUTOUTS TO LOCK IT IN PLACE. SNUG DOWN ALL 14 FLATHEAD SCREWS (M) AT THIS POINT SO THE CHAIR CAN BE MOVED ONTO ITS FEET.

**ATTACH
OTHER SIDE**

5/7

CONVERSATION MGP PATIO CHAIR

STEP FIVE: TAKE EACH ARM AND ENGAGE THE BACK END OF IT INTO THE SLOT IN EACH SIDE PIECE. TAP IT BACKWARD TO FULLY ENGAGE THE SLOT. THE FRONT OF THE ARM SHOULD FIT ONTO THE ARM SUPPORT. SECURE EACH ARM WITH 2 SCREWS (L) AS SHOWN. DO NOT OVERDRIVE THE SCREWS - JUST ENOUGH TO MAKE THE SCREW HEAD FLUSH WITH THE SURFACE.

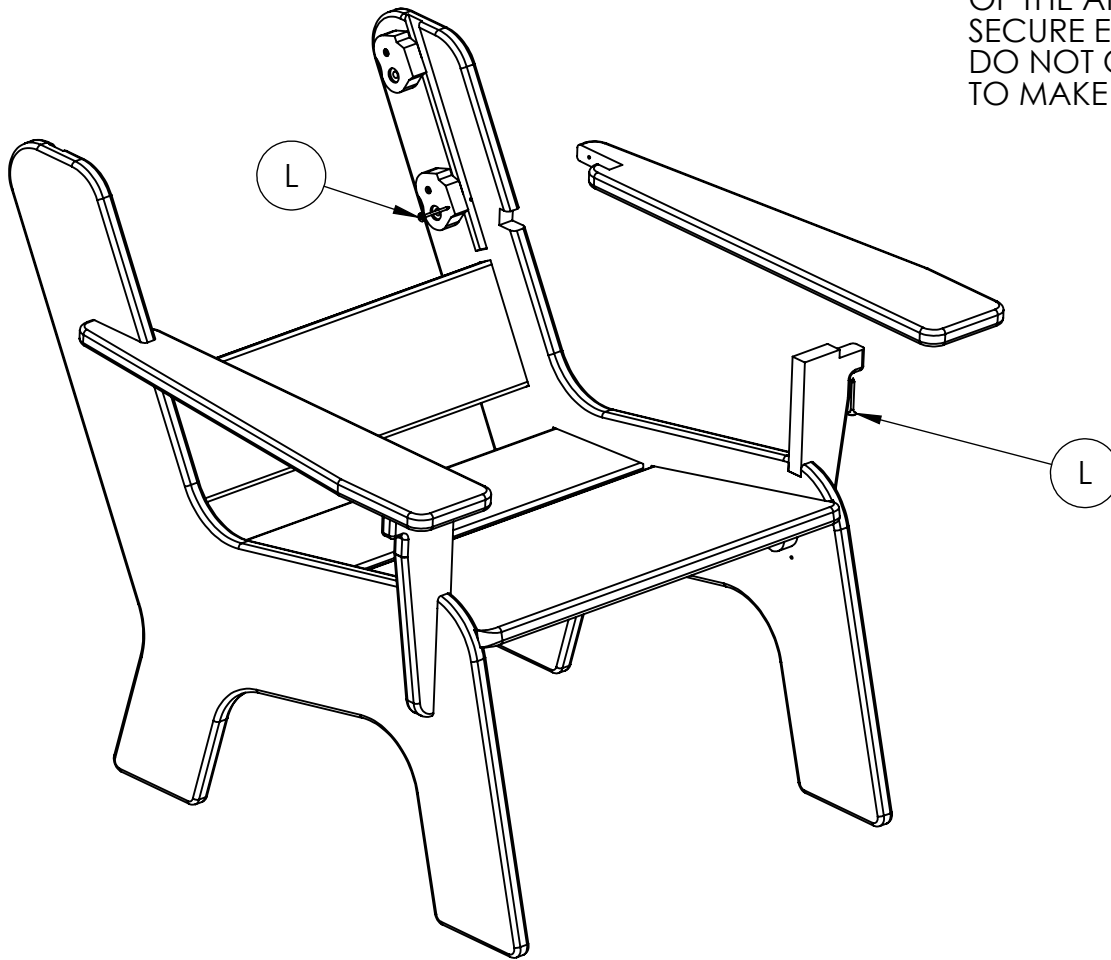

INSTALL ARMS

6/7

CONVERSATION MGP PATIO CHAIR

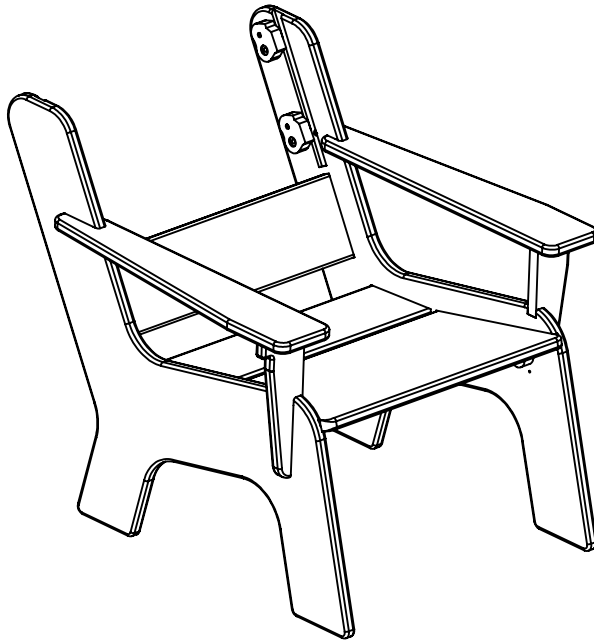

STEP SIX: SLIDE THE CHAIR BACK INTO THE SLOTS IN THE CHAIR SIDES AS SHOWN. ONCE FULLY ENGAGED, ROTATE CAMS TO LOCK IN PLACE. GO BACK AND FULLY TIGHTEN ALL 1-1/4" MACHINE SCREWS IN EACH CAM.

CONVERSATION MGP PATIO CHAIR

KCF2415
REV #1
11/13/24

ALL DIMENSIONS ARE SHOWN IN INCHES

TOP

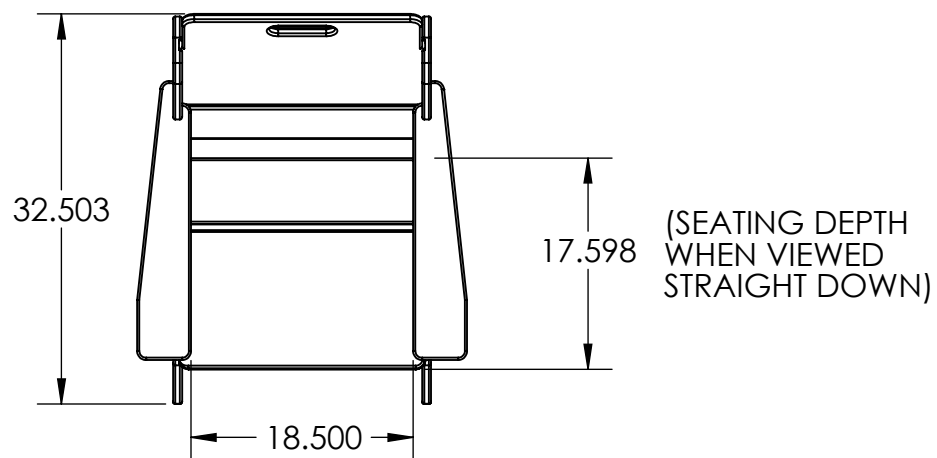

FRONT

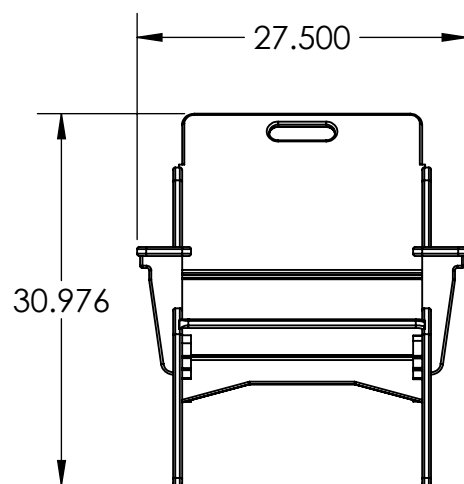

BROKEN-OUT SECTION
SHOWING HEIGHT OF
SEAT ABOVE GROUND

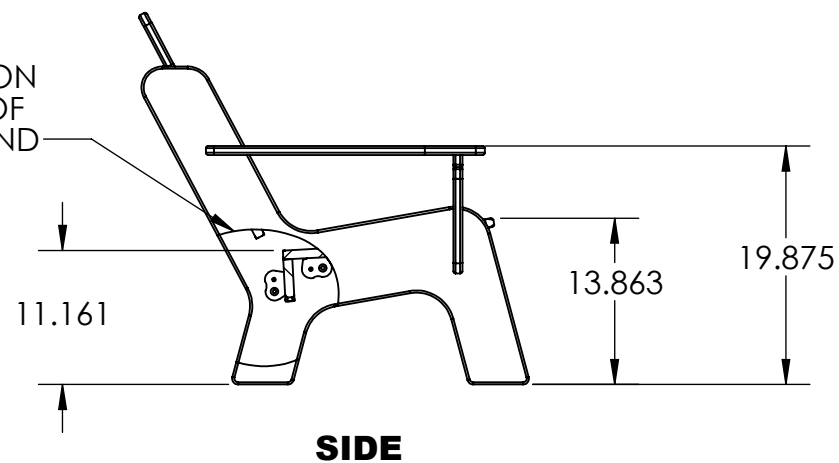

NOTE: ALL MATERIAL IS MARINE GRADE PLASTIC UNLESS NOTED