

# BIKE RACK ASSEMBLY INSTRUCTIONS

REV. 2  
10/7/2014

BK1010  
BK1015

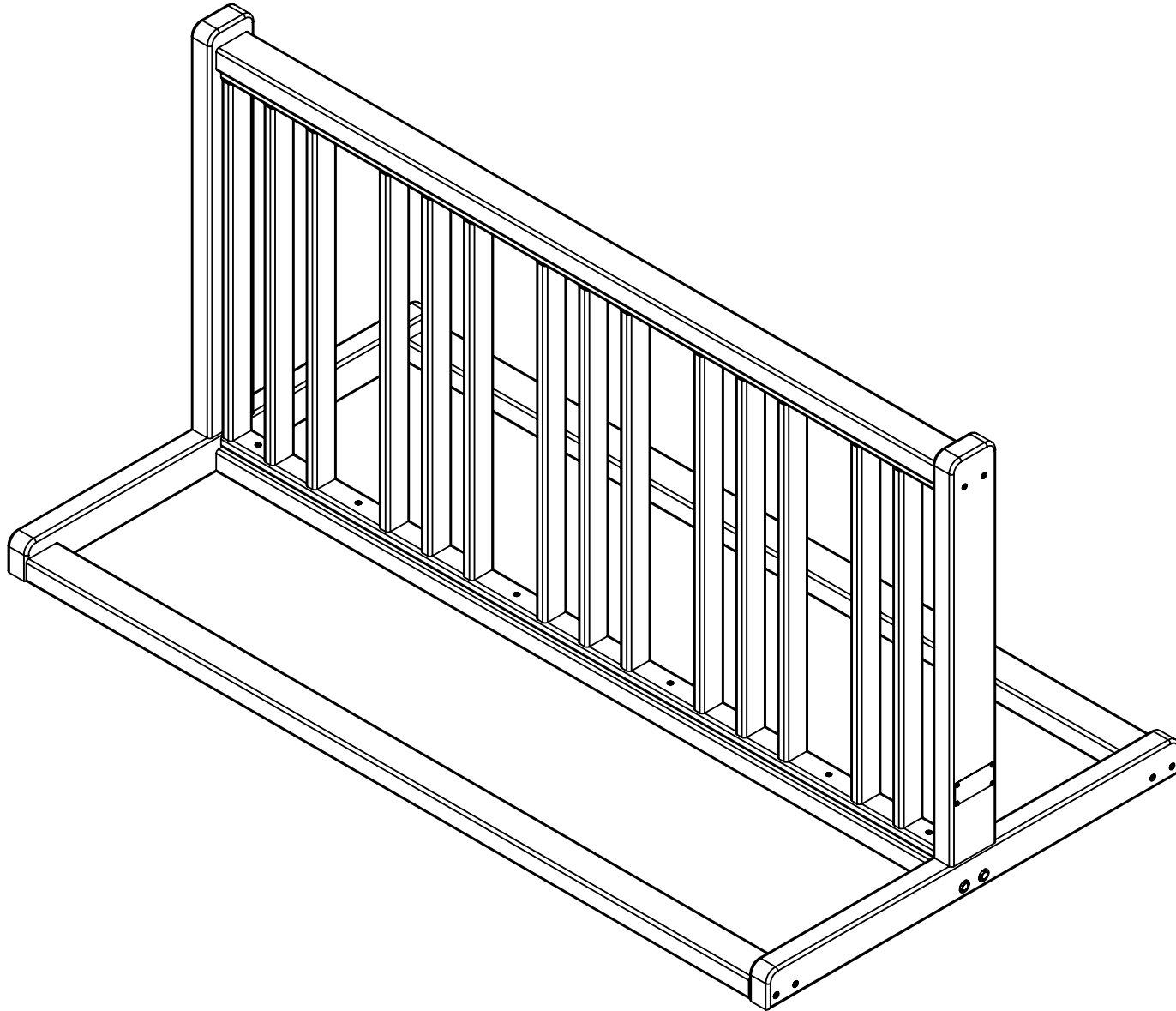

# BIKE RACK ASSEMBLY INSTRUCTIONS

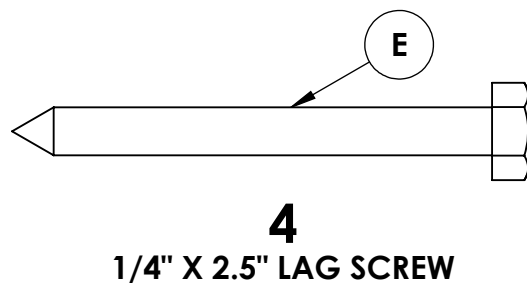
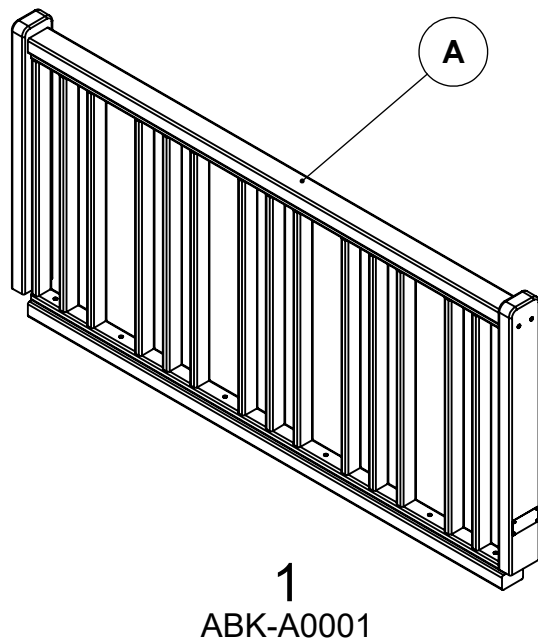

## REQUIRED TOOLS (NOT INCLUDED)

1 - 7/16" SOCKET  
1- #2 SQUARE DRIVE BIT  
POWER DRILL

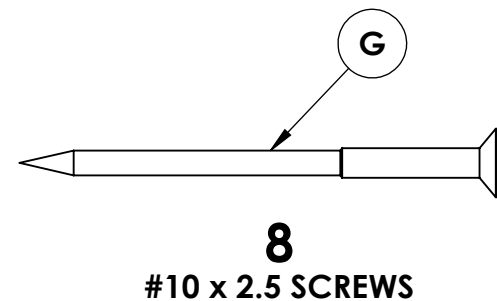
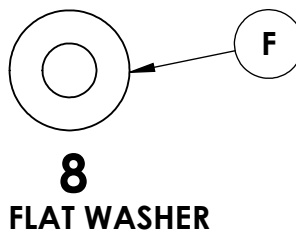
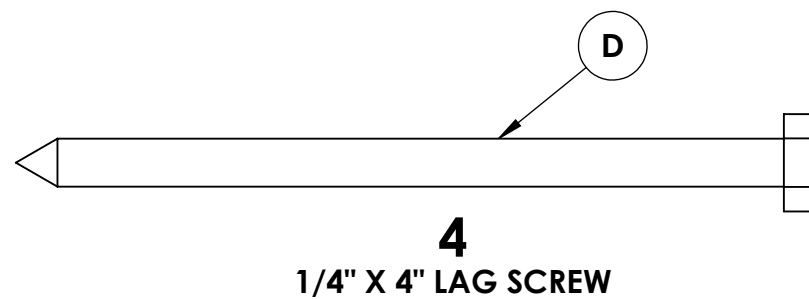
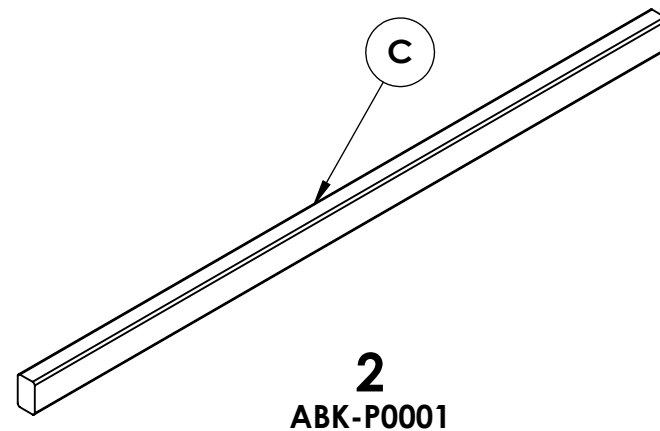
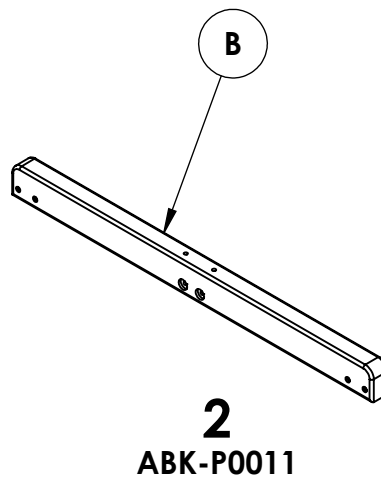

**COMPONENTS  
REQUIRED FOR  
ASSEMBLY**

**2/5**

# BIKE RACK ASSEMBLY INSTRUCTIONS

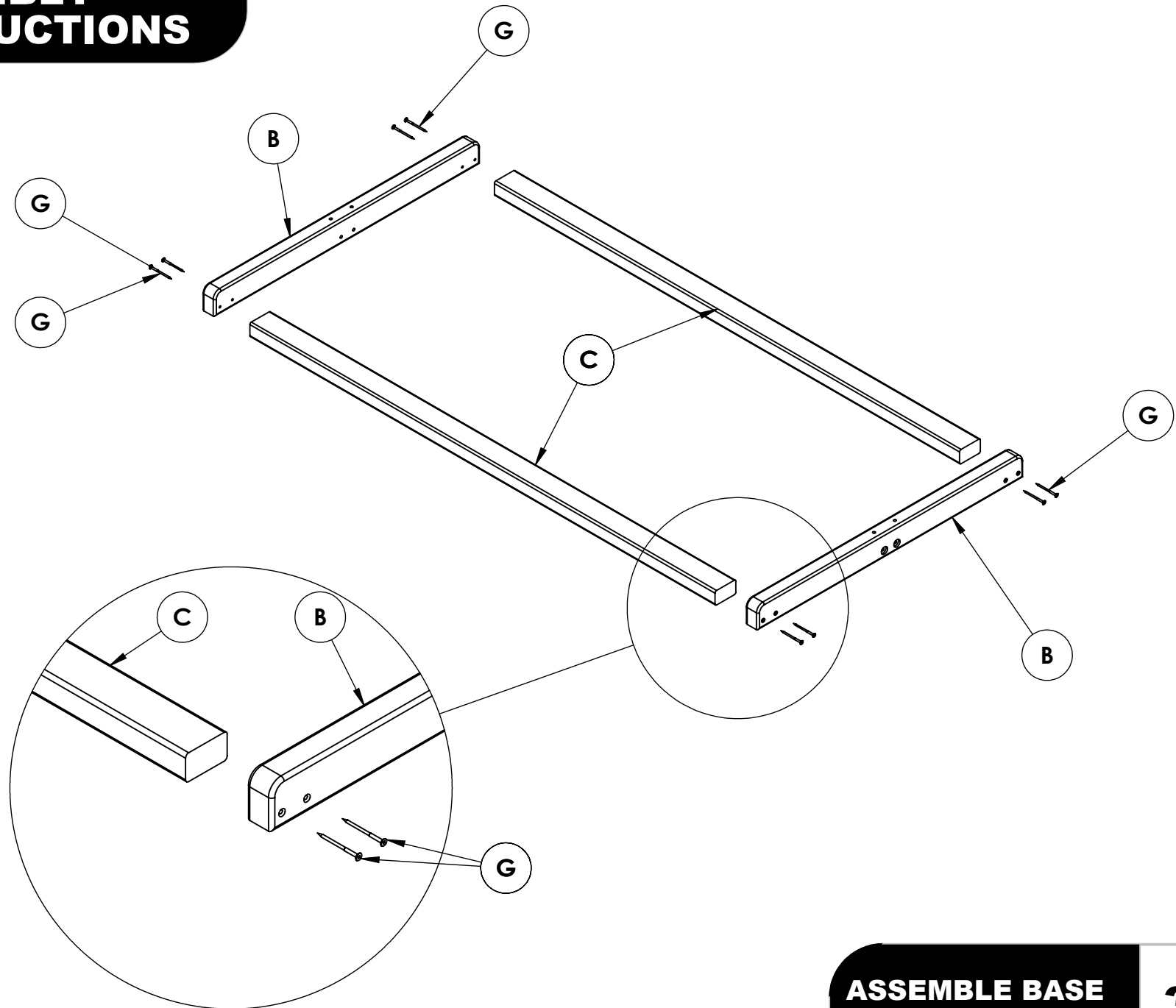

# BIKE RACK ASSEMBLY INSTRUCTIONS

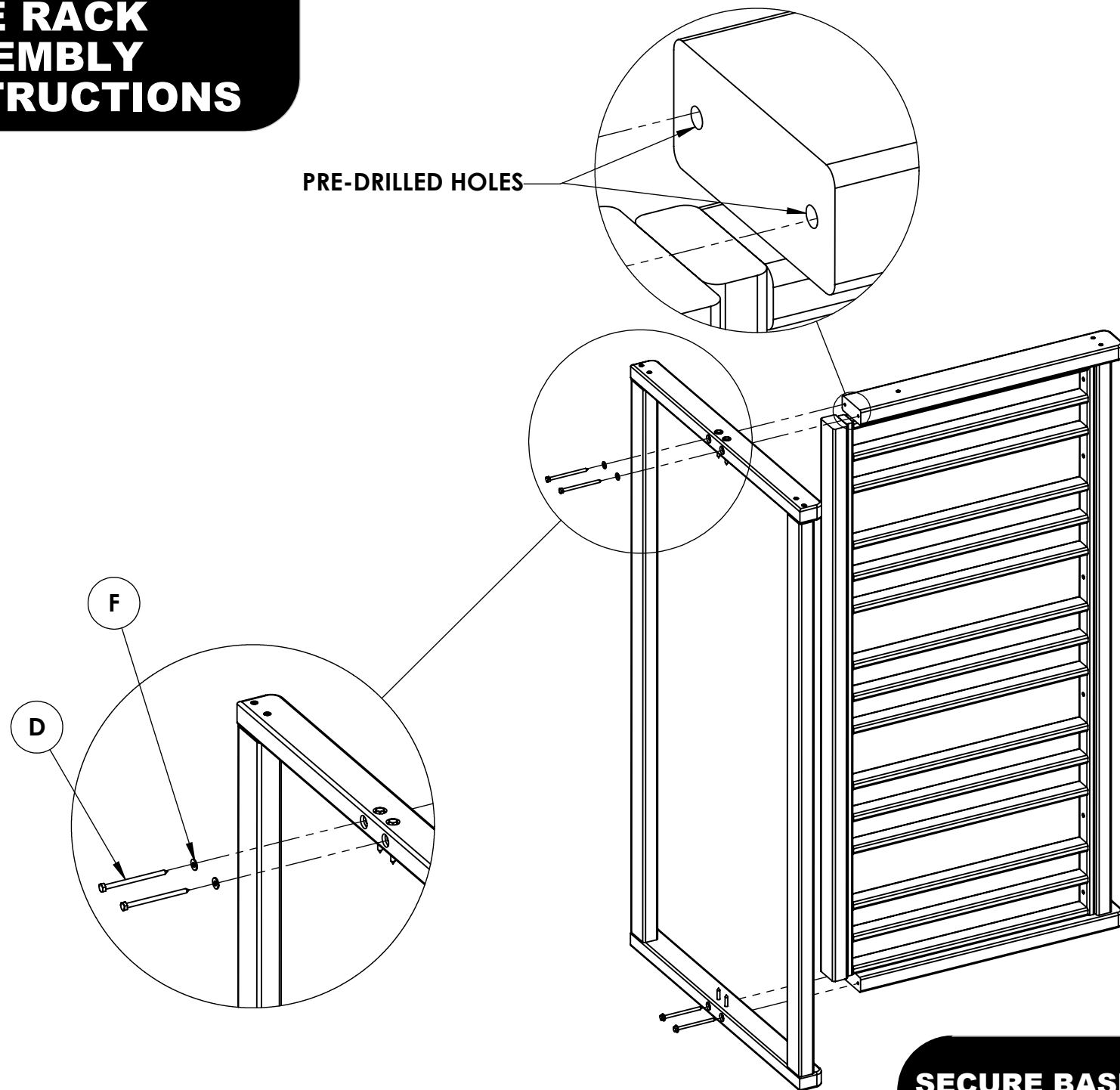

**SECURE BASE TO  
RACK**

**4/5**

# BIKE RACK ASSEMBLY INSTRUCTIONS

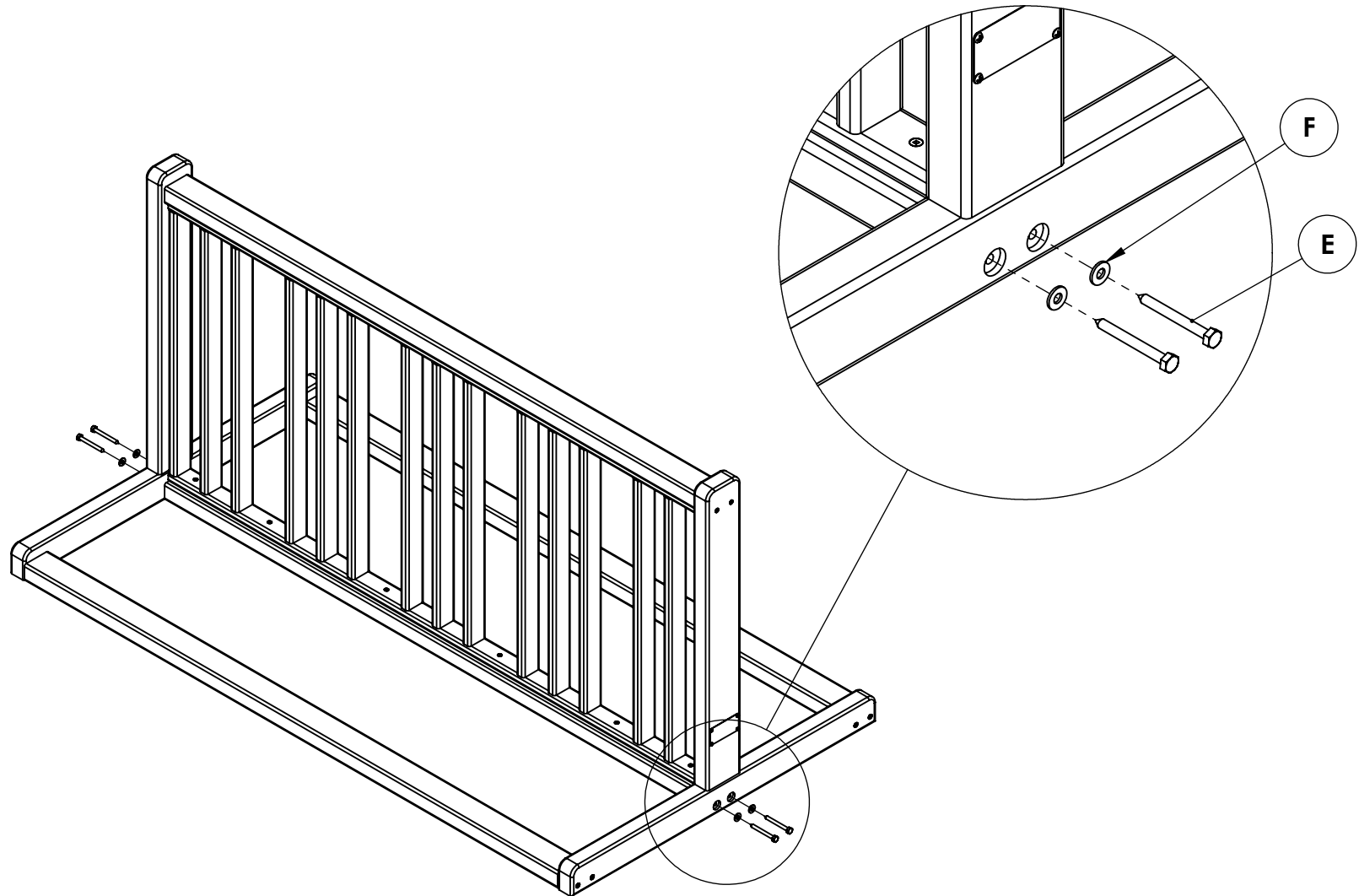

**SECURE BASE  
TO RACK**

**5/5**

# SPECIFICATIONS BK1010 - BK1015

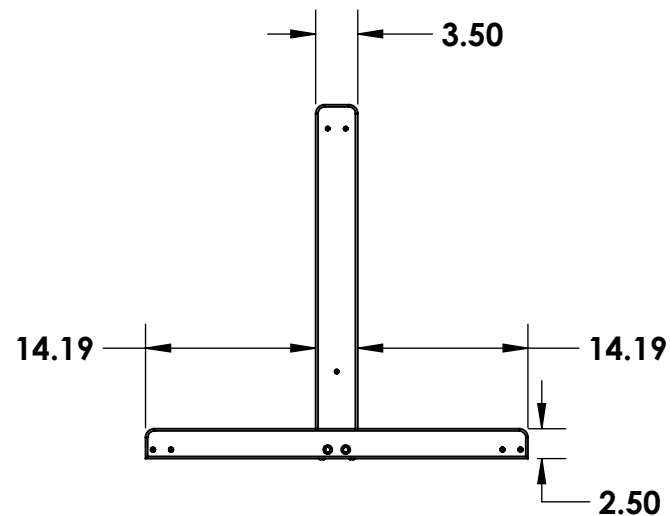
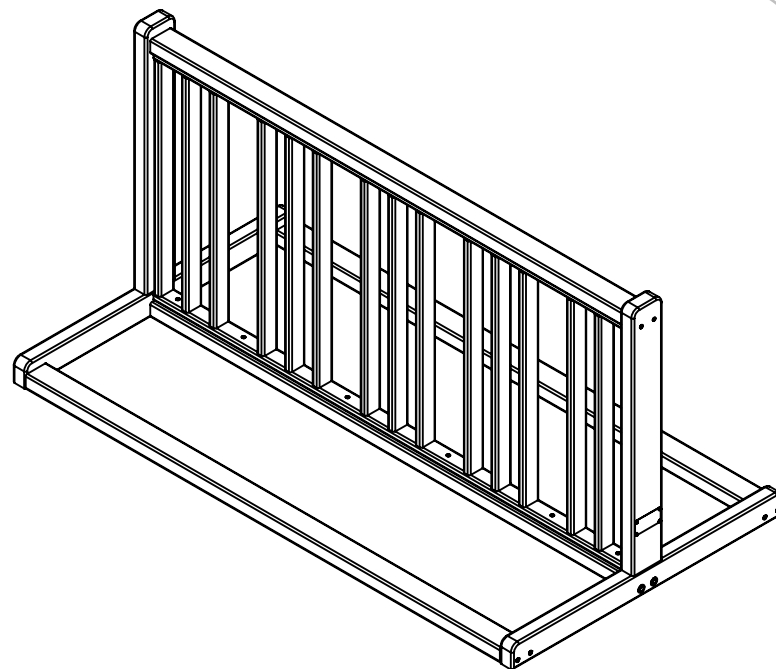
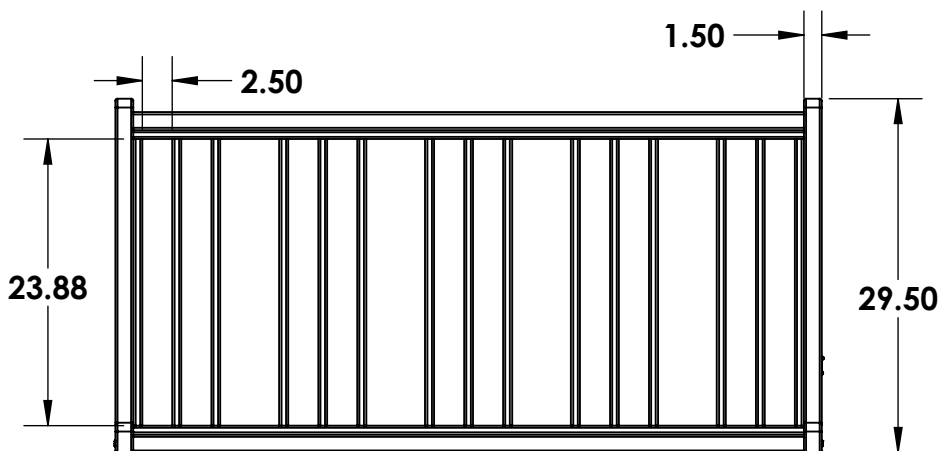
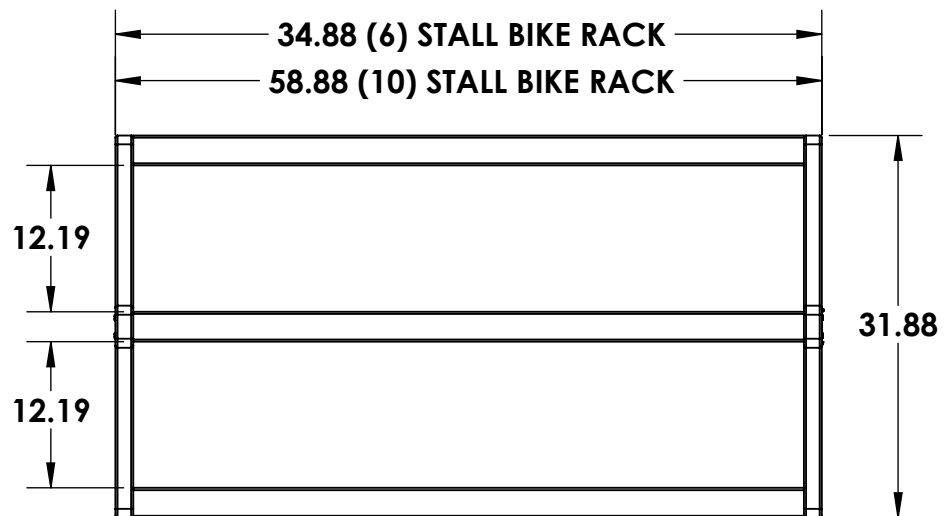

CONSTRUCTION MATERIALS:  
Recycled Plastic  
HARDWARE:  
Stainless Steel

ALL DIMENSIONS ARE SHOWN IN INCHES