

# BIKE RACK ASSEMBLY INSTRUCTIONS

REV. 3  
6/09/2021

KBK1000  
KBK1005

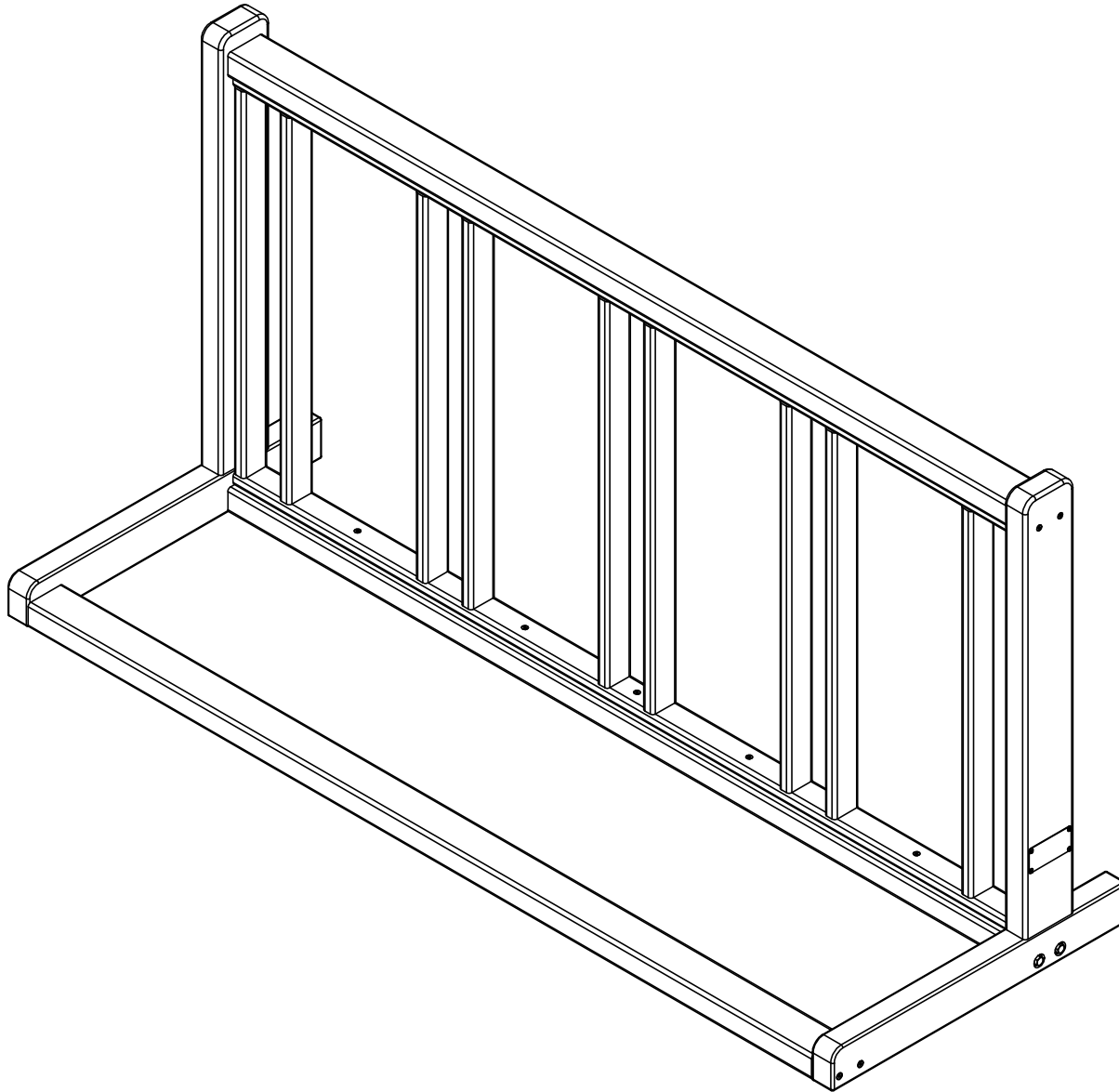

# BIKE RACK ASSEMBLY INSTRUCTIONS

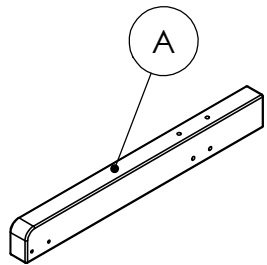

1  
ABK-P0009

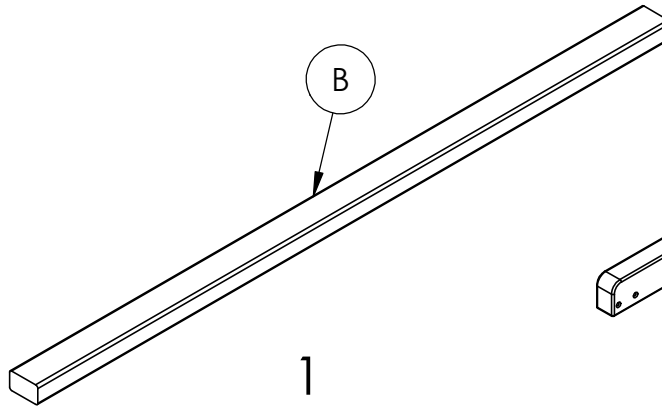

1  
ABK-P0003 (3 STALL)  
ABK-P0001 (5 STALL)

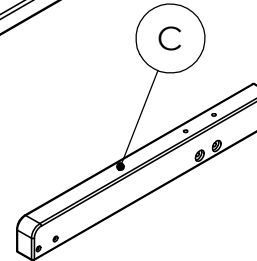

1  
ABK-P0012

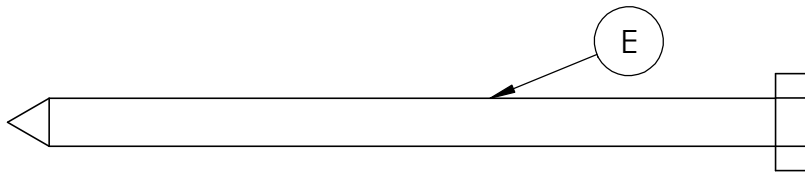
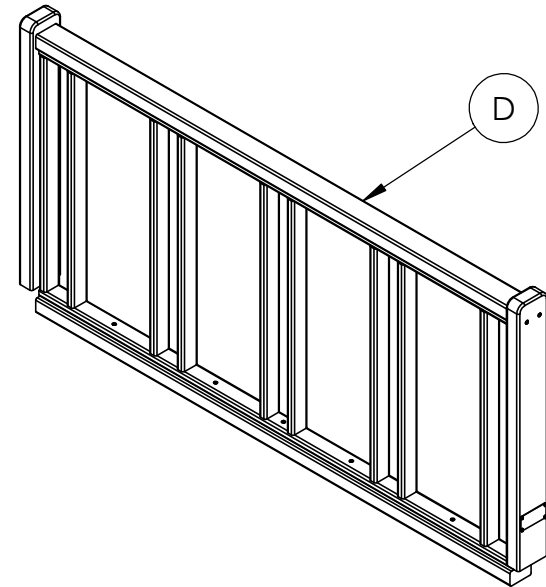

4  
1/4" X 4" LAG SCREW

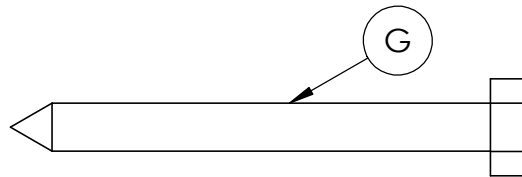

4  
1/4" X 2.5" LAG SCREW

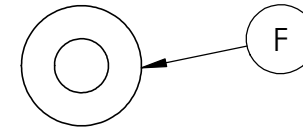

8  
1/4" FLAT WASHER

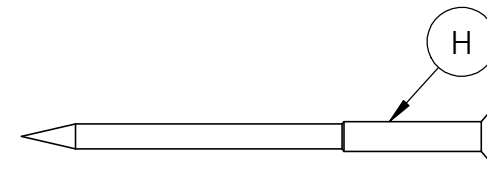

4  
#10 X 2.5" SCREW

## REQUIRED TOOLS (NOT INCLUDED)

1 - 7/16" SOCKET  
1 - #2 SQUARE DRIVE BIT  
POWER DRILL

COMPONENTS  
REQUIRED FOR  
ASSEMBLY

2/5

# BIKE RACK ASSEMBLY INSTRUCTIONS

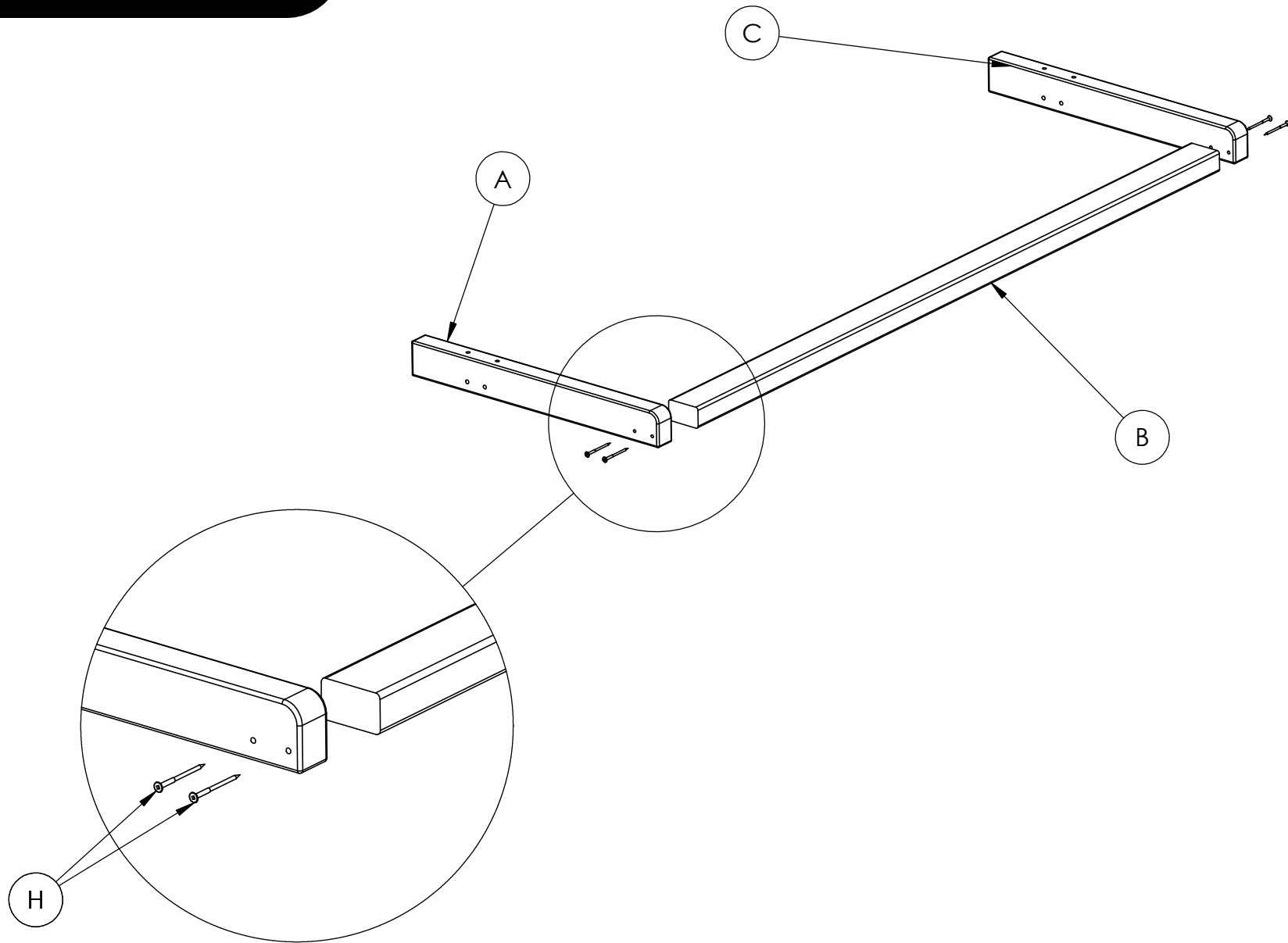

# BIKE RACK ASSEMBLY INSTRUCTIONS

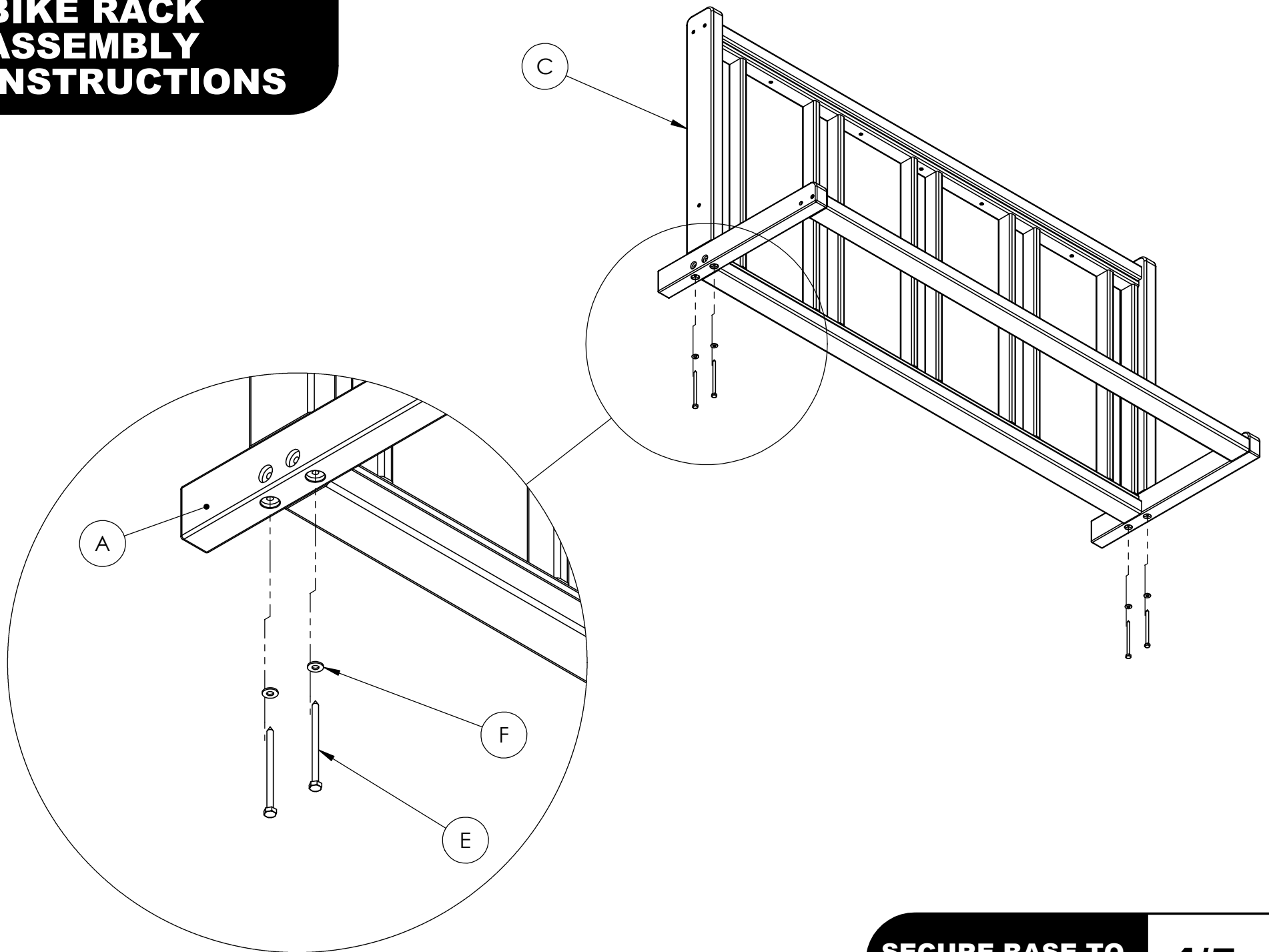

**SECURE BASE TO  
RACK**

**4/5**

# BIKE RACK ASSEMBLY INSTRUCTIONS

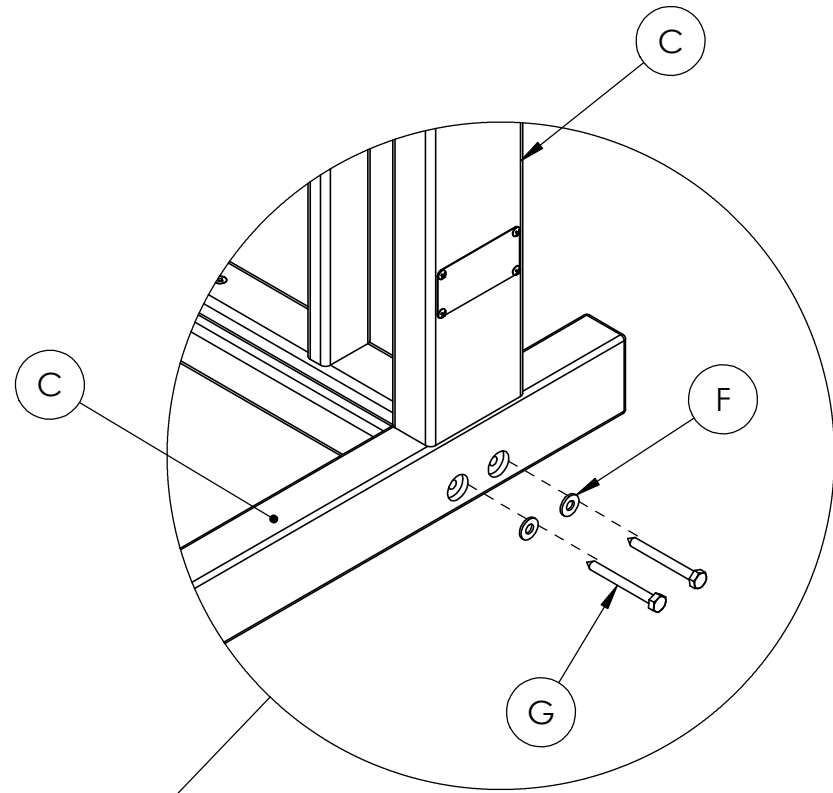
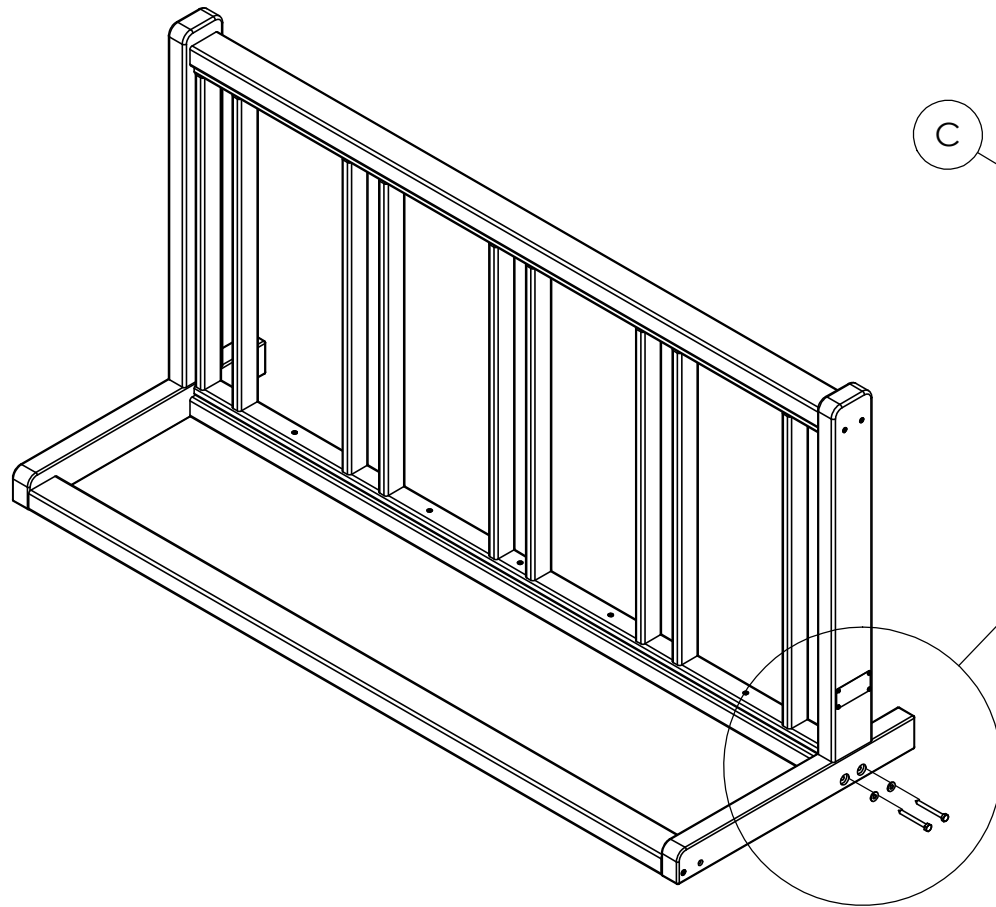

**SECURE BASE  
TO RACK**

**5/5**

# SPECIFICATIONS

## KBK1000 - KBK1005

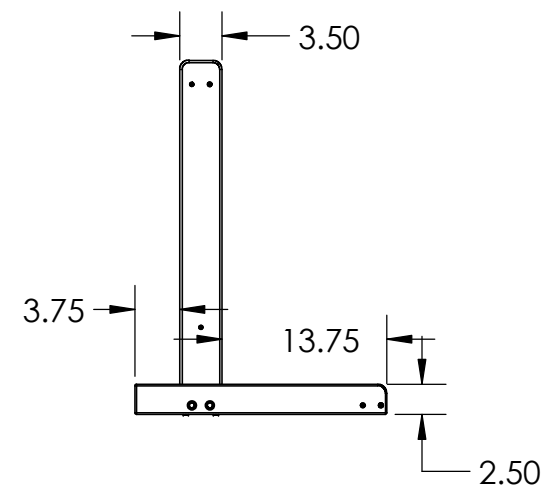
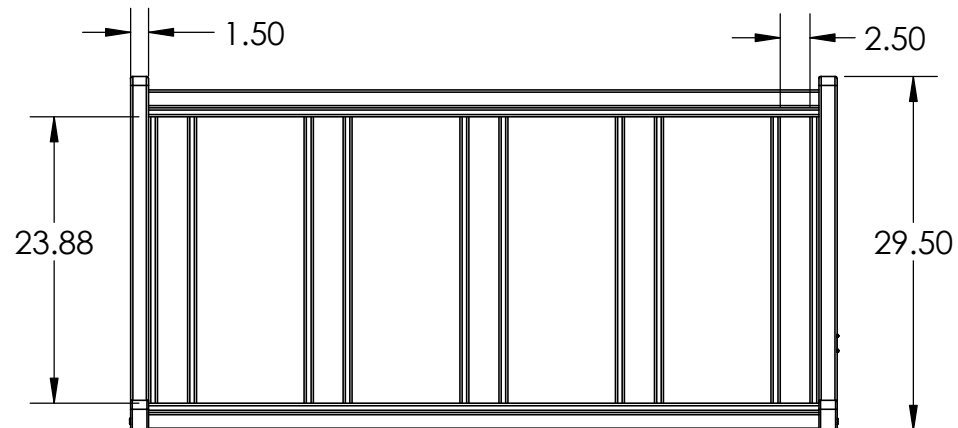
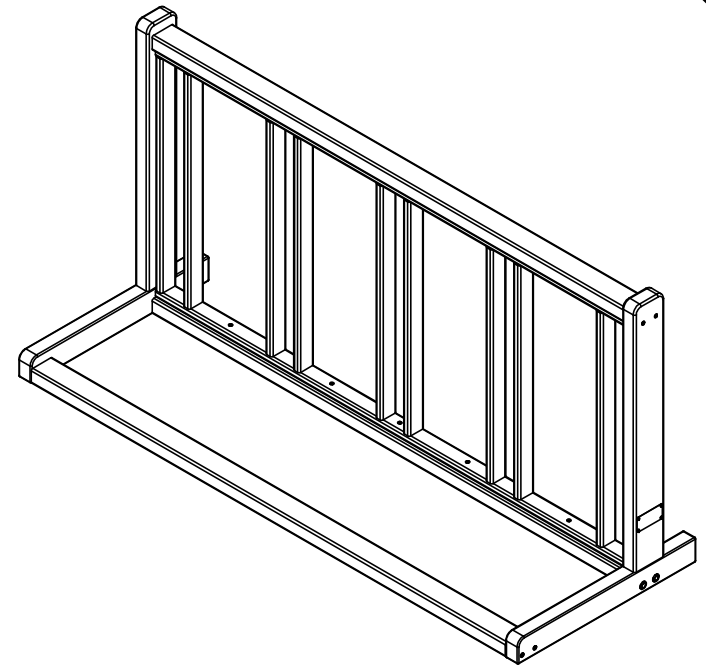
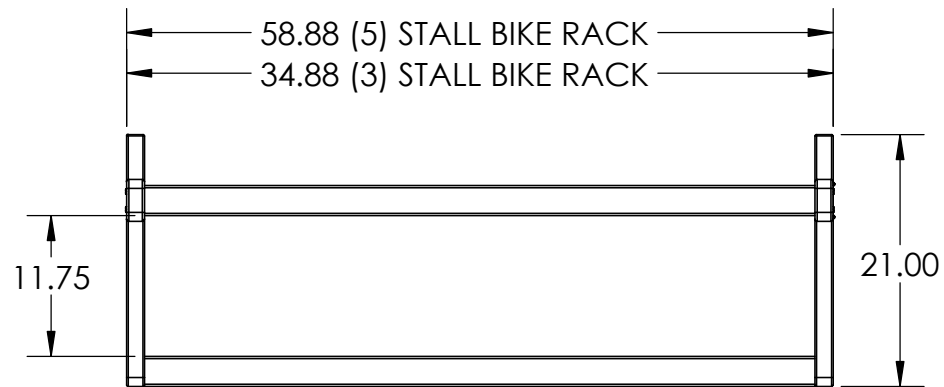

**CONSTRUCTION MATERIALS:**  
Recycled Plastic  
**HARDWARE:**  
Stainless Steel

ALL DIMENSIONS ARE SHOWN IN INCHES