

Prefabricated Shelter with Vaulted Hip Roof

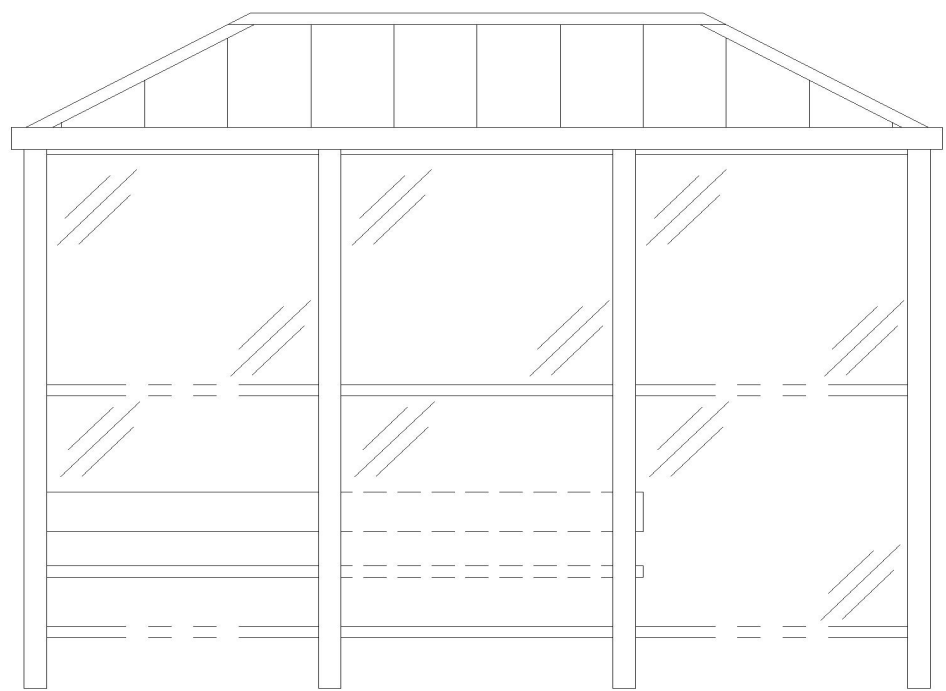

The Company tries to ensure that the shelter arrives to your location in excellent condition. If the product arrives damaged or parts are missing (or you need some installation assistance), please call Customer Service.

Tools Required for Assembly

- 1.) Rubber mallet
- 2.) Power screw gun with 1/4", 5/16" & 7/16" nut driver bits.
- 3.) Pop rivet gun
- 4.) Power drill with a 1/8", 3/16" drill bit
- 5.) 25' tape measure
- 6.) Steel claw hammer
- 7.) Caulk gun (10.3 oz. tube size)
- 8.) Chalk line
- 9.) Rotary hammer / masonry power drill with 1/4" masonry drill bit.
- 10.) Vise grips - C style with wide grip opening and end pads (clamps)

PARTS IDENTIFICATION

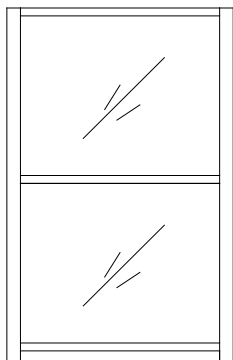

**TYPICAL VENTED
WALL SECTION**

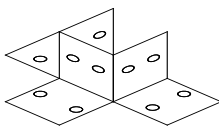

**ANCHORING SHOE
QTY – 1 PER POST**

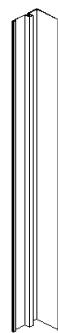

HALF POST

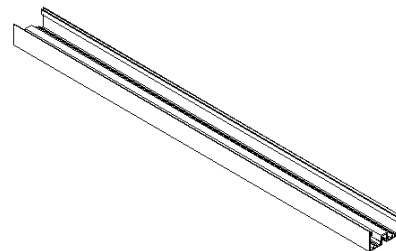

MASTERFRAME

ADDITIONAL ITEMS:

- **TOUCH-UP PAINT**

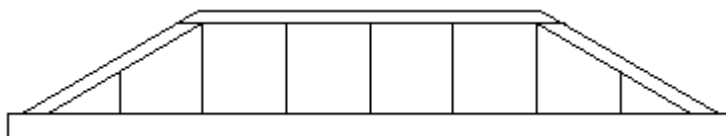

VAULTED HIP ROOF

FASTENER IDENTIFICATION

FOR QUANTITY SEE SHIPPING LIST

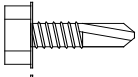

#10 x 3/4" HEX HEAD SELF DRILLING / TAPPING SCREW (COLOR OF SHELTER)

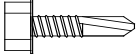

#10 x 1" HEX HEAD SELF DRILLING / TAPPING SCREW

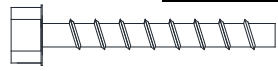

1/4 " X 1 7/8" HILTI KWIK HUS EZ ANCHOR

*******NOTE: READ ALL INSTRUCTIONS BEFORE ASSEMBLING UNIT*******

STEP 1 - Site Preparation

Shelter shall be installed on level flat ground with changes in elevation not to exceed 1/2" over the length of the shelter. The Company recommends a 6" concrete as shown on the layout drawing. Layout shelter out to out dimensions taking care to ensure layout is square.

STEP 2

Unpack the wall sections from the crate.

See Figure 1 for entrance/exit assembly(s). Screw master frame and half posts together using #10 x 1" screws. Note: Half posts are pre-drilled.

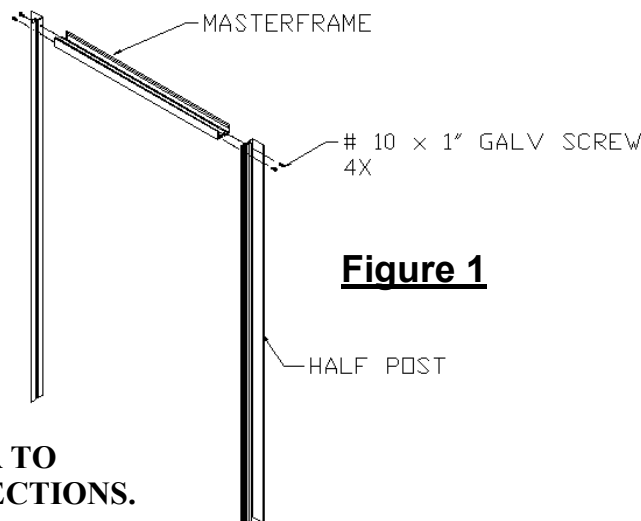

**NOTE: ASSEMBLE PRIOR TO
INSTALLING IN WALL SECTIONS.**

CAUTION: AS YOU ASSEMBLE THE SEQUENTIALLY NUMBERED PANELS BE SURE THE PANELS CREATE THE SHELTER ASSEMBLY PATTERN SHOWN IN INSTALL LAYOUT.

CAUTION: BE SURE THE SHELTER WALLS DO NOT FALL/TIP OVER DURING INSTALLATION.

STEP 3

Unpack the wall sections from the crate. Note that the wall sections are numbered, in sequence, starting at #1 and 2 and start in a corner. **See Install Layout attached.** Start with the #1 & #2 wall sections (they should make a corner connection). Stand up the Wall Sections #1 & #2 placing the corner posts male to female connections next to each other. Snap the two wall sections together by lightly hitting the sections at the connection point with a rubber mallet and continuing from the top to the bottom of the post. Proceed with the remaining wall sections in the same manner, continuing with the next appropriate number until all panels and entrance/exit assembly is complete.

Caution: Be certain wall sections are secured from falling over until shelter is fully anchored to concrete pad.

STEP 4

After all the walls of the shelter are assembled, measure from corner to corner again to ensure the shelter is square. Adjust layout if necessary.

STEP 5

See Figure 2.

Lift the hip roof into place, making sure that the drain holes are oriented correctly (none at elevation A). Secure the hip roof using #10 x 3/4" Tek screws provided @ 12" O.C.

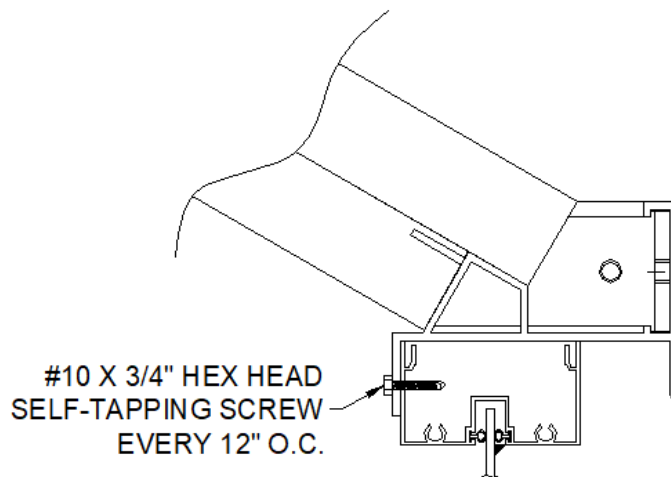

Figure 2

STEP 6 – Anchoring

Anchor the shelter to the concrete pad. **See Figure 3.**

Fit the anchoring shoes around the exterior of each of the posts. Although six holes are provided in anchor shoe, only 4 anchors per shoe are required. Mark the holes to be drilled in concrete pad using the anchor shoe as a template. Remove the anchor shoe and drill into the concrete pad. Be sure the

holes are deep enough for the Screw Anchors to anchor shelter properly. See Hilti screw anchor install attached.

Fit the anchoring shoes around the exterior of each of the posts and attach the shoes to the posts with (6) #10 x 3/4" hex head self-tapping screws in the holes provided. Screw 1/4" x 1 7/8" Hilti screw anchors provided.

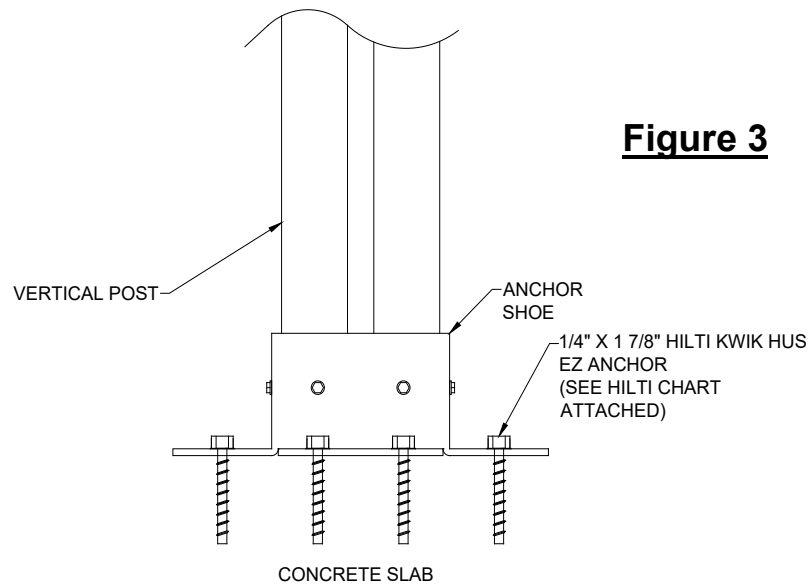

BENCH PARTS IDENTIFICATION



BACKREST – QTY: (SEE SHIP LIST)

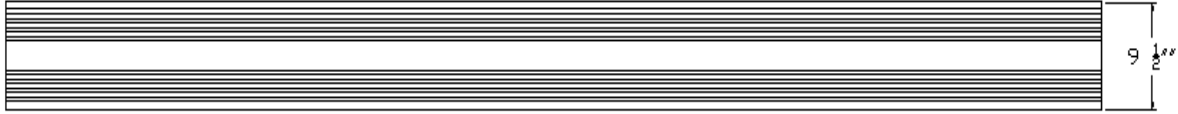

BENCH – QTY: (SEE SHIP LIST)



BACKREST BRACKET – QTY: (3)

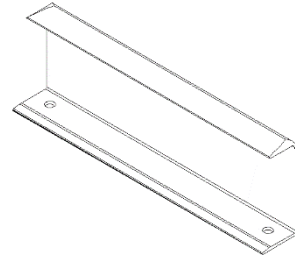

END CAP – QTY: (4)

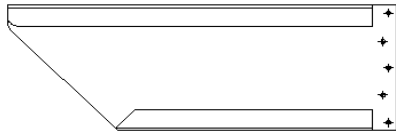

BENCH SUPPORT LH – QTY: (1)

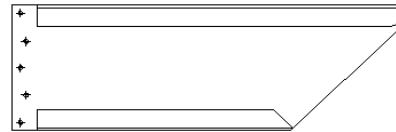

BENCH SUPPORT RH – QTY: (2)

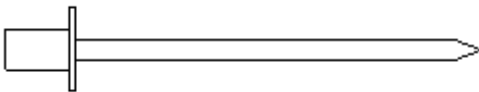

3/16" ALUMINUM POP RIVETS

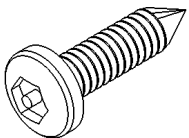

1/4" X 1" STAINLESS STEEL SELF TAPPING SECURITY SCREWS

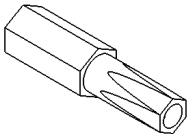

#T27 6 LOBE SECURITY BIT

STEP A.

Installation of the bench.

- A. Drill 3/16" diameter holes through 9 1/2" bench and 6" backrest using predrilled holes in end cap as guide, 2 per end cap. **See Figure 1**
- B. Secure end caps to bench and back rest with 3/16" pop rivets. (2 per end Cap)

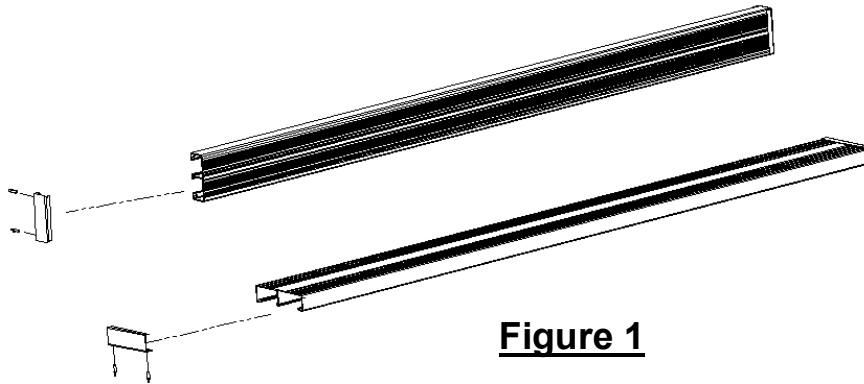

Figure 1

Locate bench supports on posts. **See Figure 2.** Note orientation of support at corner. **See Figure 2, Detail A.** Supports must be level, one to another. Using #T27 6 lobe security driver bit provided, secure bench supports to posts with 1/4" stainless steel self-tapping security screws, 5 per bench support.

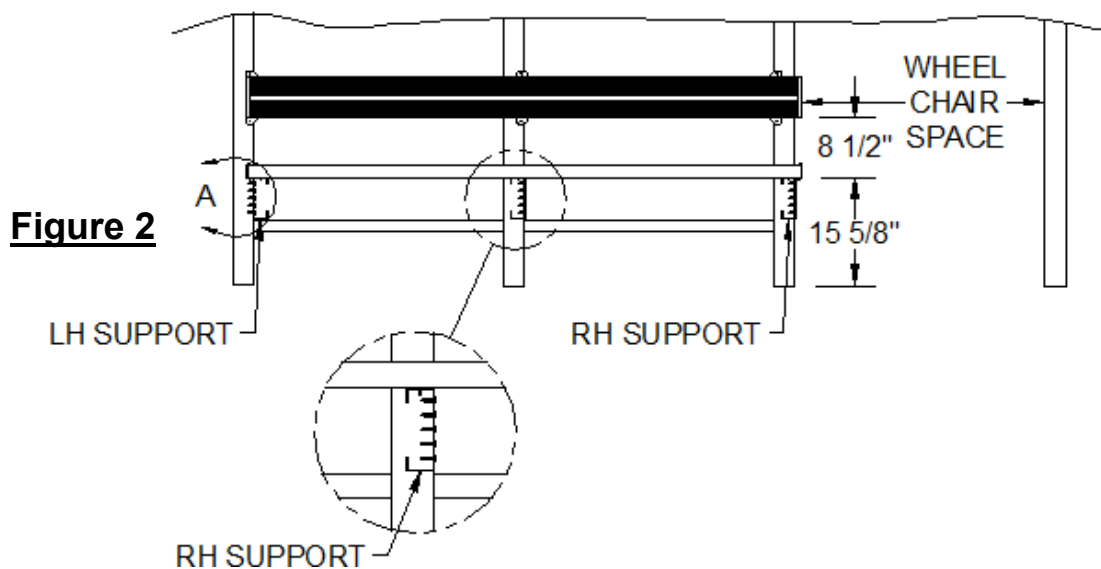
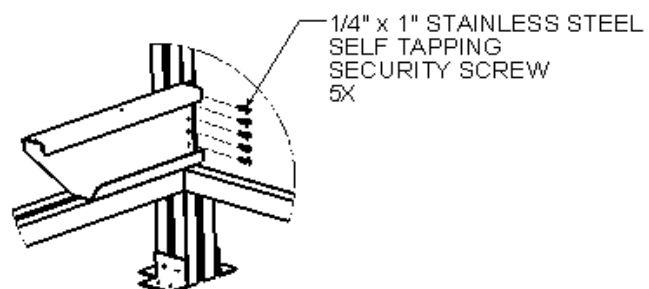

Figure 2

Figure 2 – Detail A



Installation of the bench (cont.)

STEP B.

Place the 9 ½" bench planks on top of the supports. Clamp in place. **See Figure 3.** Drill 3/16" diameter holes through the benches using the predrilled holes in the bench support as a guide, 2 per bench support. **Caution: drill holes through underside flange only.** Secure the benches to the supports with 3/16" diameter pop rivets, 2 per bench support. Remove clamps.

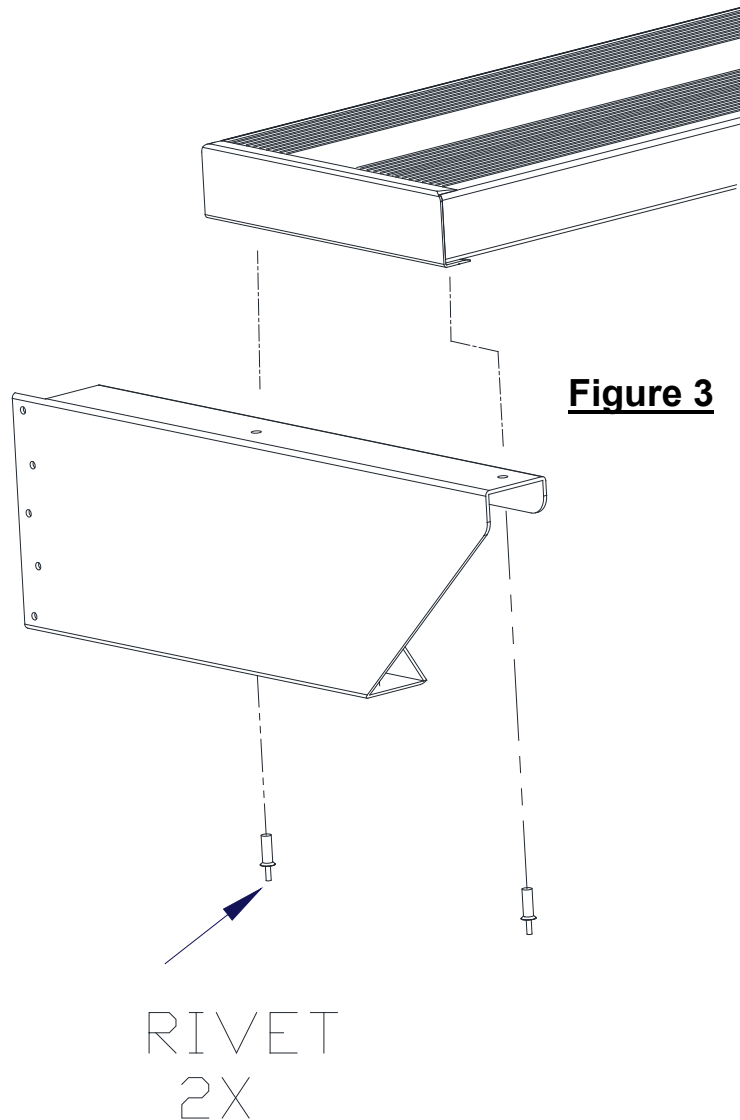

Installation of the bench (cont.)

STEP C.

Lay backrest on its face and layout backrest bracket locations on backrest spaced as shown below to allow attachment to posts. Clamp in place. Drill 3/16" diameter holes through backrest using predrilled holes in backrest bracket as guide, 2 per backrest bracket. **Caution: drill holes through the rear flange of backrest only.**

See Figure 4. Secure backrest bracket to backrest with 3/16" pop rivets, 2 per backrest bracket. Remove clamps.

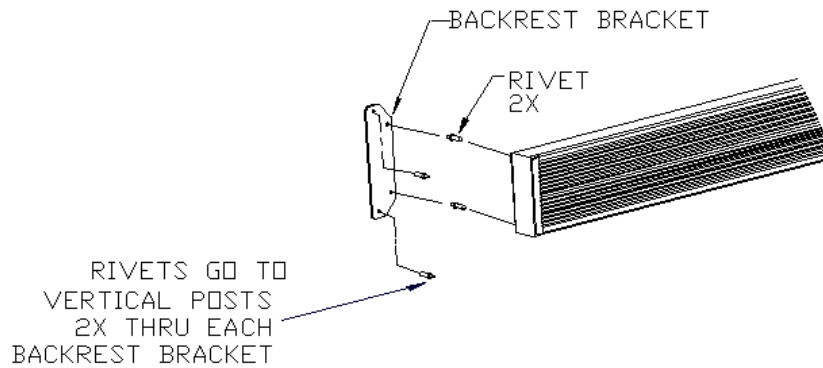

Figure 4

STEP D.

Locate backrest on posts. Backrest must be level. **See Figure 5.** Drill 3/16" diameter holes through posts using predrilled holes in backrest bracket as a guide, 2 per post. Secure backrest brackets to posts with 3/16" pop rivets, 2 per post.

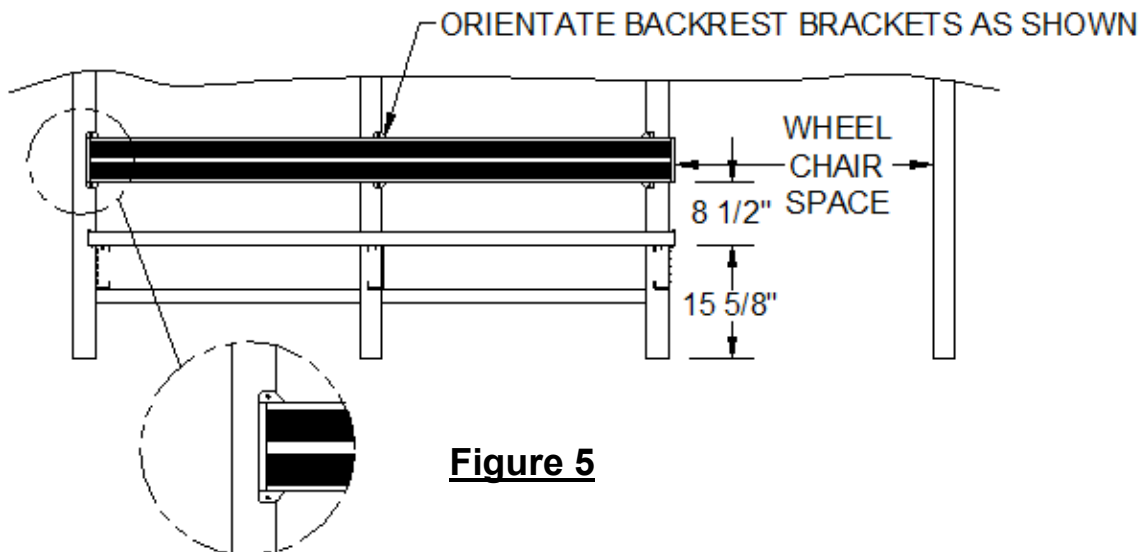

Figure 5

Call our Customer Service
if you need clarification of these assembly instructions.