

BENCH INSTRUCTIONS

CF1105 REV# 2

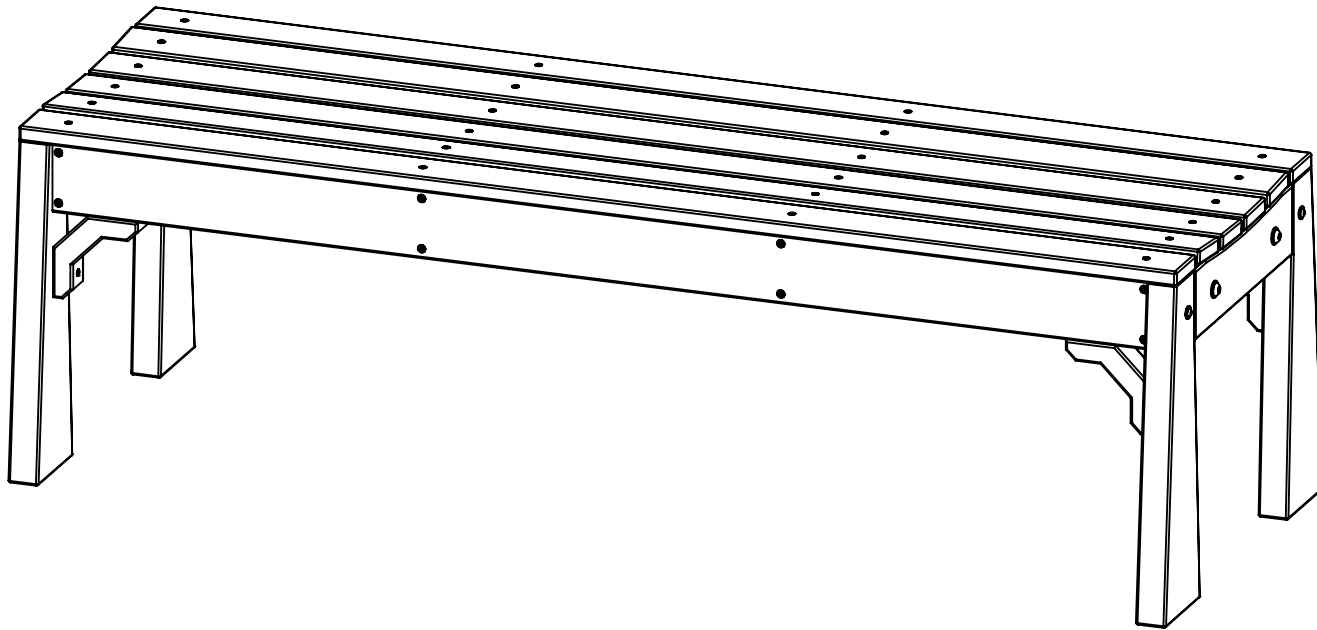

BENCH INSTRUCTIONS

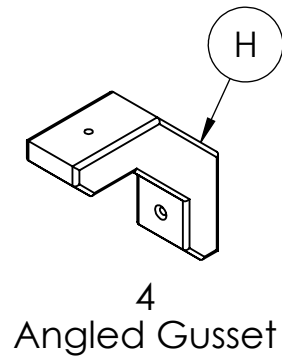
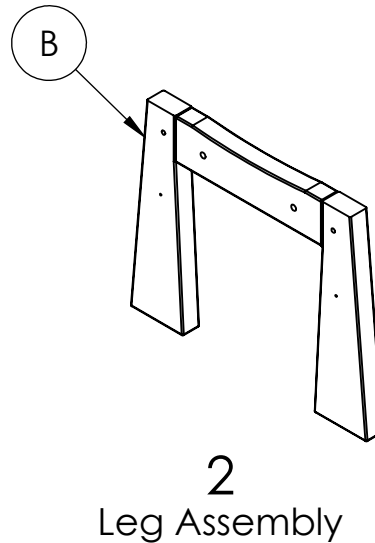
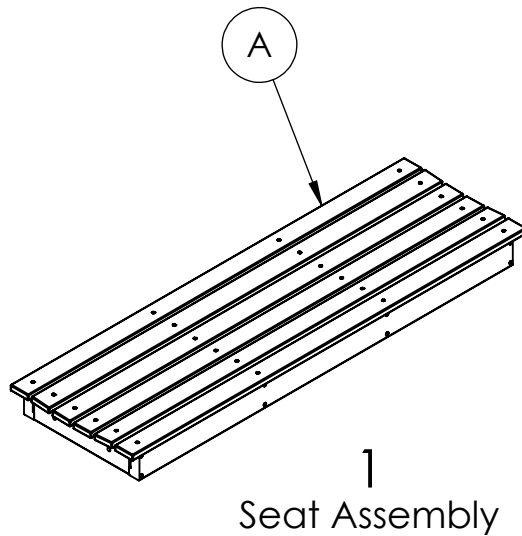

REQUIRED TOOLS (NOT INCLUDED)

- POWER DRILL
- 7/32 ALLEN WRENCH
- 9/16 WRENCH
- #2 SQUARE DRIVE

**NOTE: IT IS IMPORTANT TO KEEP ALL
SCREWS LOOSE DURING ASSEMBLY
UNTIL ENTIRE BENCH IS ASSEMBLED**

HARDWARE

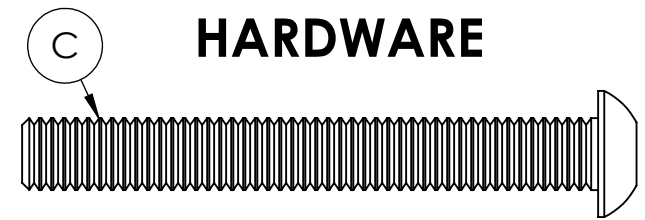

4
3/8" x 3" Button Head Cap Screws

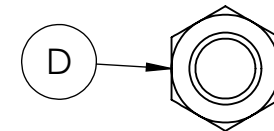

4
3/8" Hex Nuts

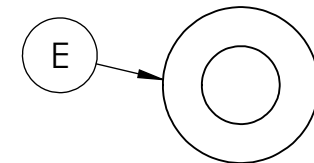

8
3/8" Flat Washer

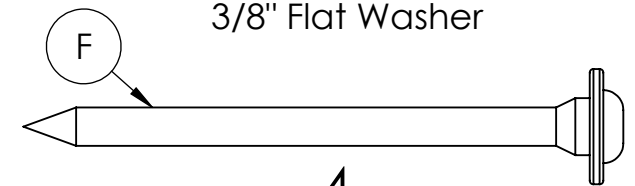

4
Truss Lag Screw

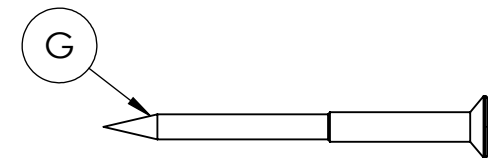

8
#8 x 1.625" Flat Head Screw

**HARDWARE &
TOOLS REQUIRED
FOR ASSEMBLY**

2/5

BENCH INSTRUCTIONS

STEP 1

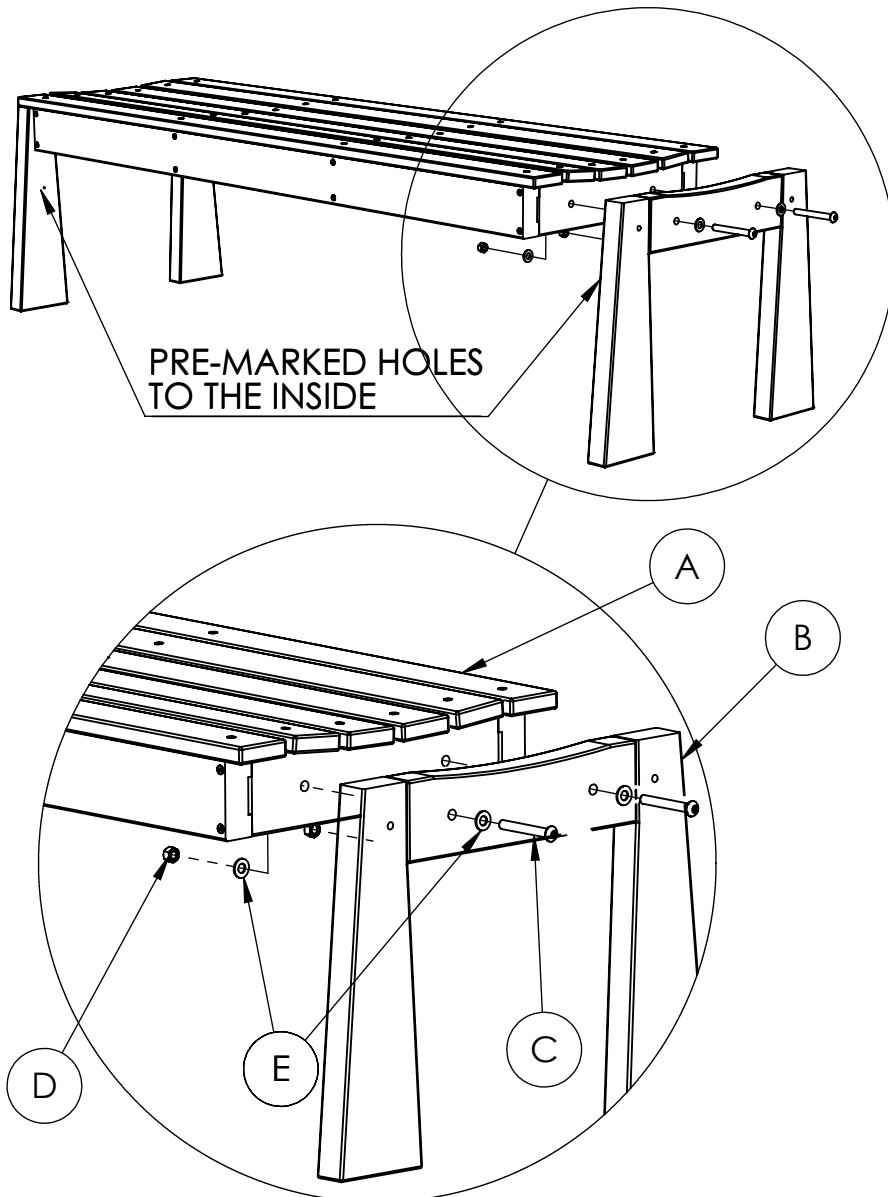

STEP 2

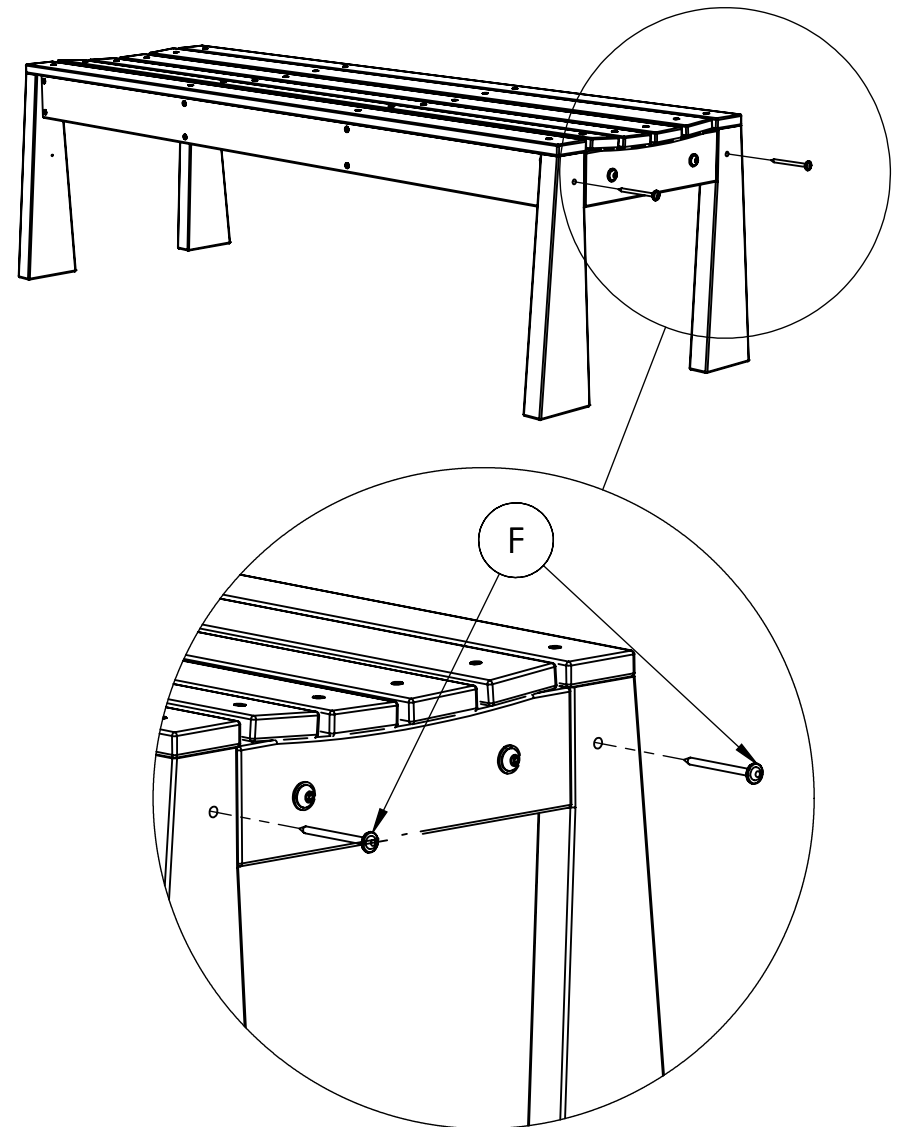

BENCH INSTRUCTIONS

STEP 3

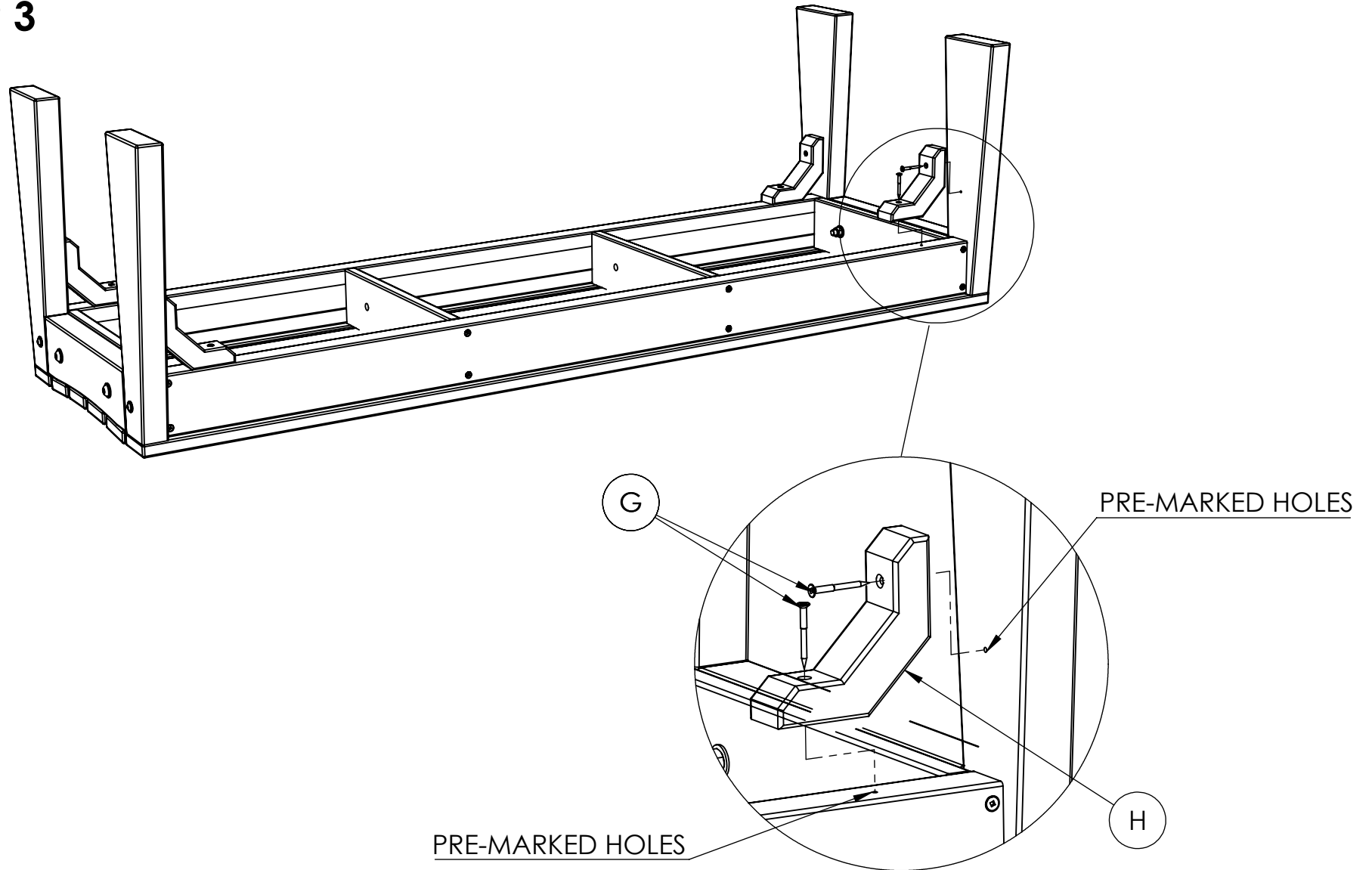

BENCH SPECIFICATIONS

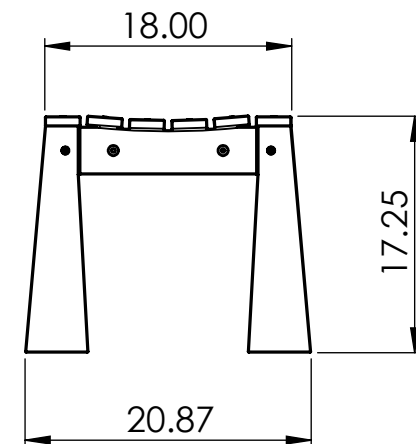
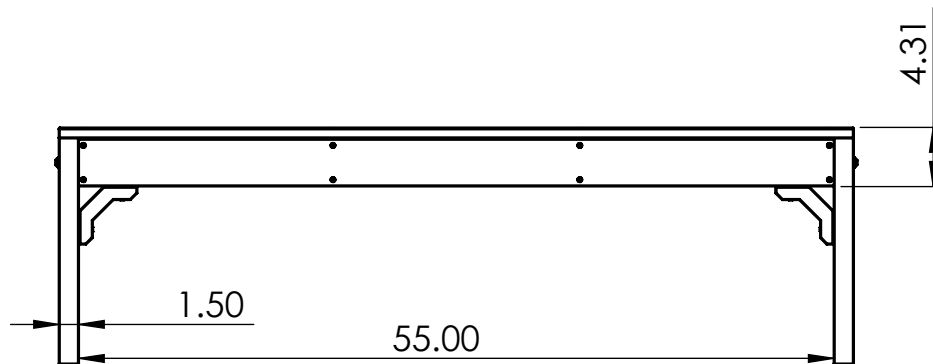
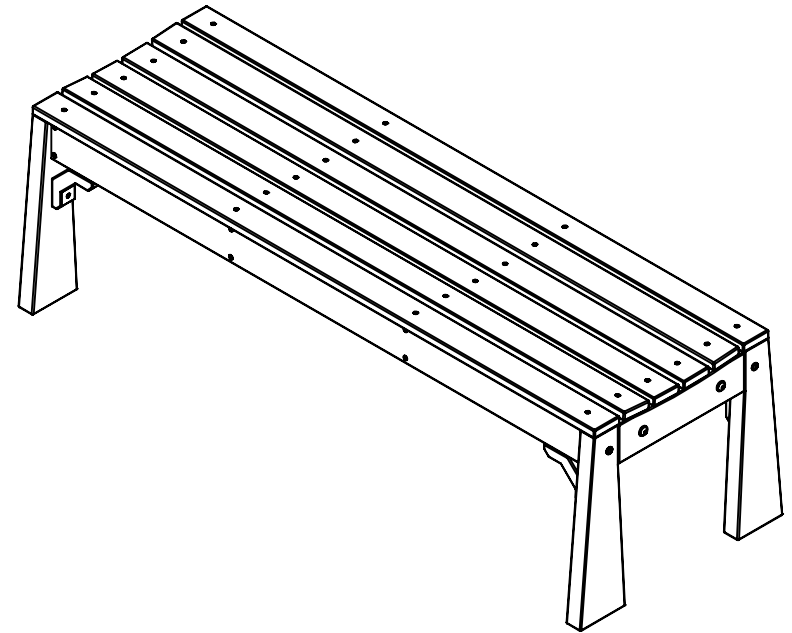
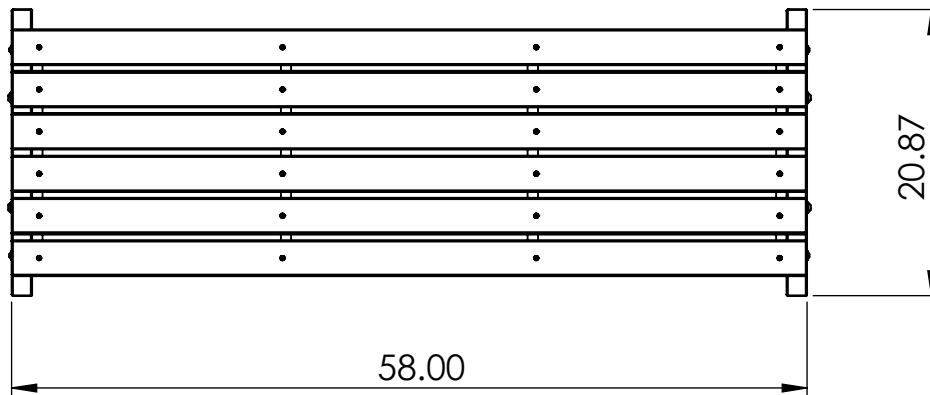

CONSTRUCTION MATERIALS:
Recycled Plastic
HARDWARE:
Stainless Steel

ALL DIMENSIONS SHOWN IN INCHES